



EAE



2026

# ABOUT US



Since 2003, we, EAE Automotive Equipment Company Limited, with manufacturing facility in Wujiang and over 300 employees, focusing on passenger and commercial vehicle service lifts, have been one of the most professional players in the automotive aftermarket.

In recent years, we have taken great stride in market expansion both overseas and in China. With a complete range of passenger vehicle lifts under 8000KG load capacity and commercial vehicle service lifts under 80Tons that are manufactured in-house at our Wujiang manufacturing facility, our products and solutions have been commissioned in over 90 countries. In addition, we have been exceptionally successful in domestic passenger vehicle lift market, winning numerous awards, projects, approvals, and certifications from a number of car manufacturers.

However, because of our realizing that the market is ever changing and competition increasing, we never ignore our heavy focus in research and development, and product FMEA/longevity testing, product training, and demonstration of our products and solutions.

We hope that you join us in this journey, so that together we can bring our businesses to a new level of success.

EAE is not only your vehicle lift supplier, but your partner.



**5/2/2 WARRANTY POLICY**  
 5 years for lift structure  
 2 years for hydraulic components  
 2 years for electrical parts

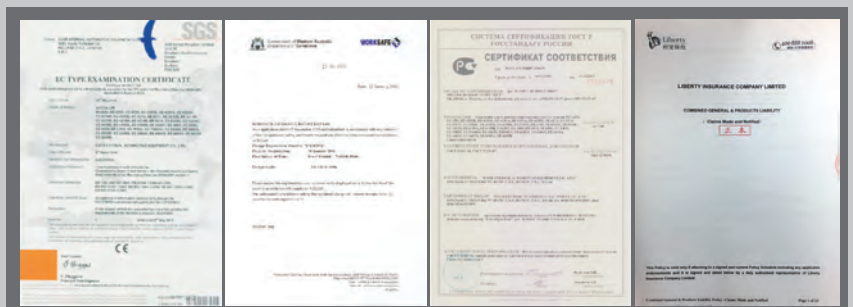

# COMPANY EVENTS

2003

Founded

2004

Gradually obtained CE, ISO9001: 2000, Australian WorkSafe, GOST Russia certifications.



2007

Established manufacturing facility in Wujiang.



2008

Obtained Approval from GEA/VOSA UK for EAE's 4-Post Car Lift with optional play detector to be part of the MOT vehicle testing process in the UK.



2012

Renamed Ever-Eternal to EAE (Everlift And Everet).



2014

Set up EAE UK branch office to begin trials and explorations of international operations.



2018

Mobile Lifting Table, which designed for dismantling and fixing batteries of electric vehicles, successfully developed.



2020

Vehicle Lift Intelligent Management System successfully developed.

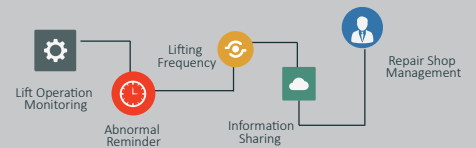

2022

A series of intelligent lifts were successfully launched, including mobile column vehicle lifts and new generation 2-post lift.



2024

Wider application of wireless lifting technology.



2025

Independent Scissor Lift introduced to market.



# INDEX



## QUIKMULTI



CE

E25 5.0T



CE

E26 6.5T



CE

E28 8.0T



CE

SYMMETRIC or ASYMMETRIC

62C 3.5T/4.2T



CE

SYMMETRIC or ASYMMETRIC

62C 4.5T



CE

62C 5.0T/6.0T



CE

62B 3.5T/4.2T/5.0T

## One Hand Operation



CE

C9M/C10M 3.5T/4.2T



C9Z/C10Z 4.0T/4.5T



SYMMETRIC or ASYMMETRIC

C12 5.5T



CE

F9M/F10M 3.5T/4.2T



CE

6435S/B 4.0T/5.0T



CE

6435S/B 6.5T

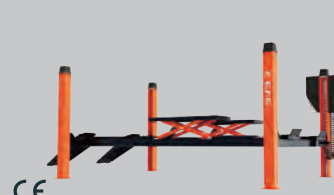

CE

6435BWF 4.0T/5.0T



CE

E410S 10T



CE

MOT&ATL LIFTS

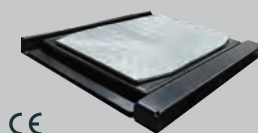

CE

PD/PD8

Axle load up to 4.0T  
2014/45/EU

# INDEX



LS45 4.5T

6501 3.5T

HS40 4.0T

6503 3.5T



MR35 3.5T

MR30 3.0T

MS12M 1.2T

MS12MF 1.2T

MS10 1.0T

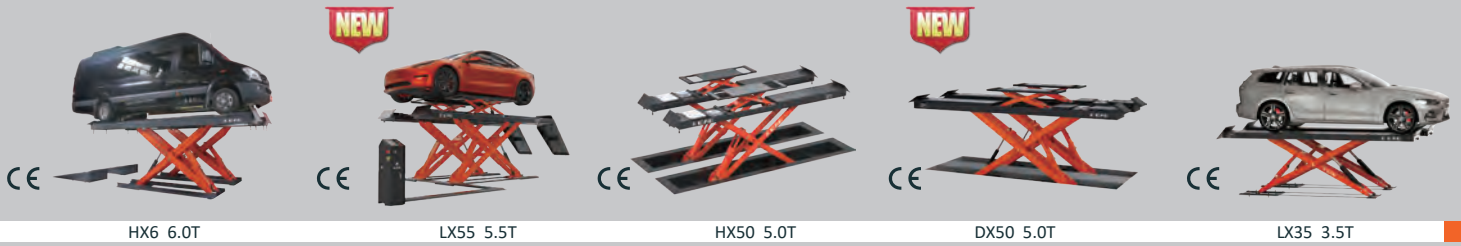

HX6 6.0T

LX55 5.5T

HX50 5.0T

DX50 5.0T

LX35 3.5T



HX150 15T

EX8B 8.0T



CJ 3.0T

SCJB 3.0T

J40E 4.0T



MLH10/MLH10D 1.0T

## Mobile Columns



HDM 8.0T/10T

HDM W 8.0T/10T

HDM G 8.0T/10T

Wireless  
Easy and Convenient

Independent Columns  
No Steel Ropes

25 Seconds  
Full rise



# QUICKMULTI



E25



E25  
Type M Arms (Optional)



## E25

### INDEPENDENT TWO COLUMN LIFT

- Rated capacity 5000kg, suitable for most sedans, heavy-duty SUVs, pickup trucks and vans.
- Flexible installation width to accommodate various vehicle sizes and installation spaces , recommended range: 2800-3500mm.
- A maximum pick-up height of 2000mm, providing greater under-vehicle workspace.
- Wireless synchronized hydraulic control system , capable of correcting height variations during lifting cycles.
- 24V safe control available at both columns for convenient and efficient operation.
- Touchscreen display for system setup and real-time height monitoring.
- Dual power units (3.5kW x 2) for powerful capability, only 25 seconds from bottom to top under rated load.
- Aluminium Shell Motor: Rapid dissipation, consistent efficiency.
- Dual safety against hydraulic leakage through mechanical latch and anti- burst hydraulic valve.
- Smart latch sensors decide whether to lower directly or raise before descent.
- APS control allows direct descent ( safety lock disengaged) for rapid positioning
- Low-position stop and audible alarm for the final travel . No rail guards on the lift arms.
- Automatic engaging and disengaging swing arm locking device. Engage when raised and disengage at the lowest position.
- Optional M-Arms provide extensive wheelbase compatibility.

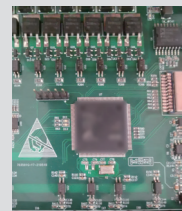

Intelligent Control System

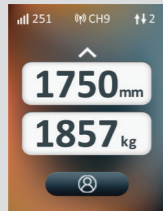

HMI Screen  
(Optional Load Display)



Control Panel



Height Limit Switch and  
Displacement Sensor



Four 3-Stage Arms

### OVERALL DIMENSION

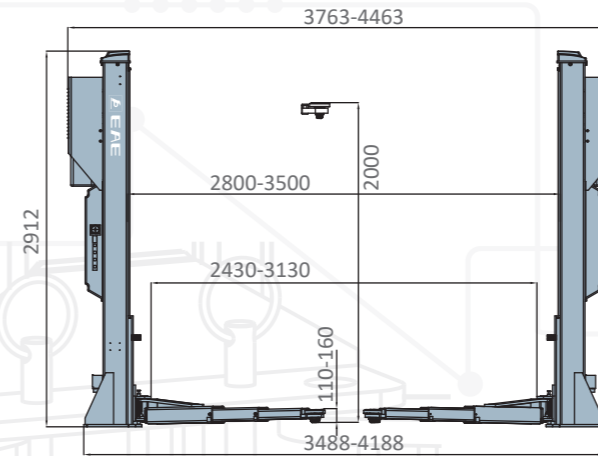

E25

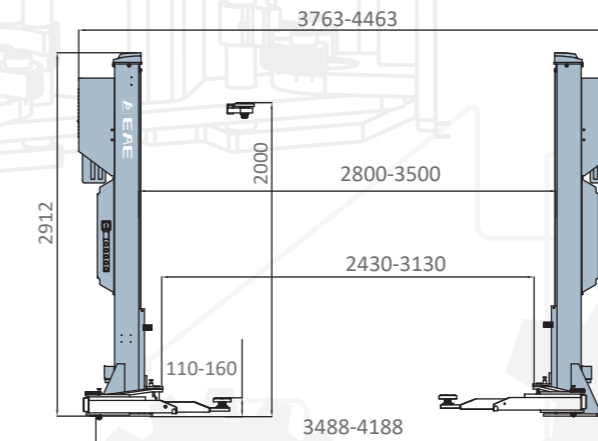
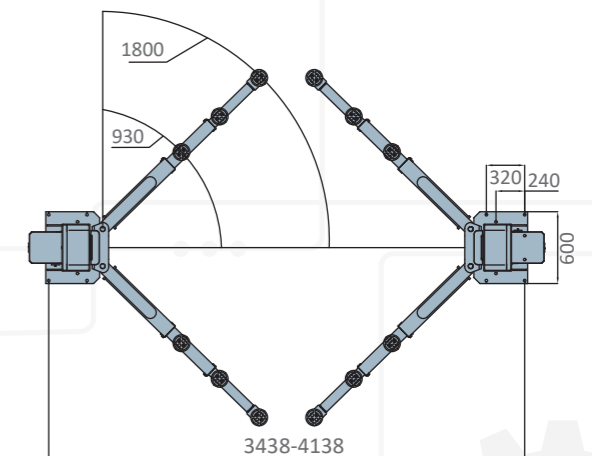

E25  
Type M Arms

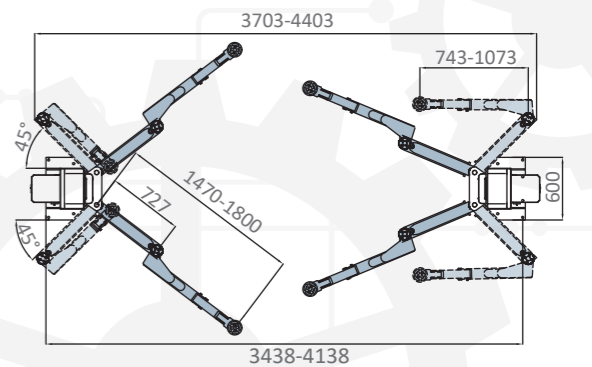

\* The dimension schemes above illustrate the optimally designed column spacing. This spacing can be reduced based on available space constraints and vehicle models when necessary.

### TECHNICAL DATA

| MODEL NO.                        | E25                         |
|----------------------------------|-----------------------------|
| Lifting capacity                 | 5.0T                        |
| Max lifting height               | 2000mm                      |
| Min height                       | 110mm                       |
| Lifting time                     | Approx. 25S                 |
| Motor                            | 3.5kWx2                     |
| Drive-through width (Adjustable) | 2430-3130mm                 |
| Overall height                   | 2912mm                      |
| Electricity supply               | According To Customer Needs |

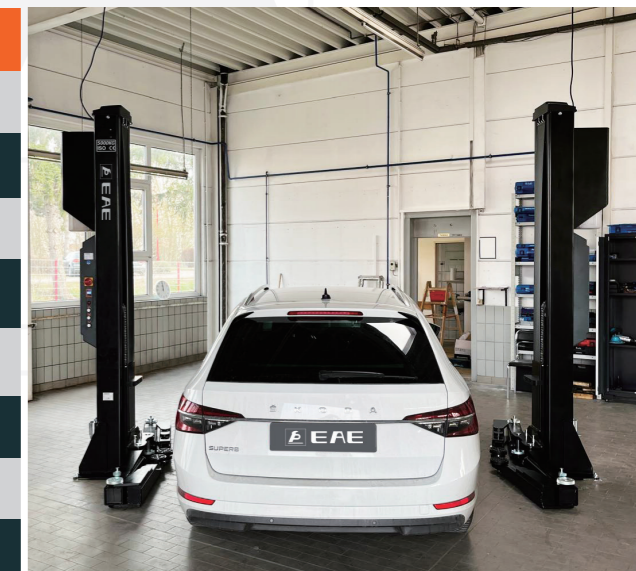

\* Max. Lifting height is measured with adjustable screw pads in highest position.  
\* Machine shown with optional equipment. Actual product appearance may differ.

Wireless | Independent Columns | M Arms | CE  
 Easy and Convenient | No Steel Ropes | Standard

QUIKMULTI



OVERALL DIMENSION

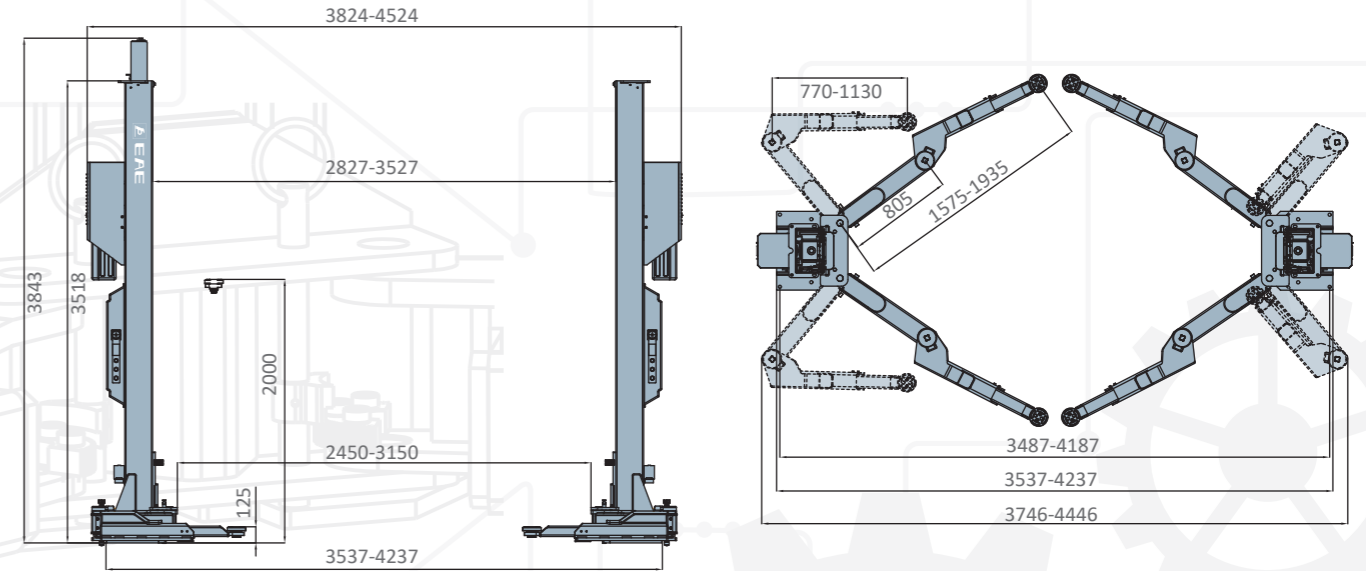

TECHNICAL DATA

|                                  |                             |
|----------------------------------|-----------------------------|
| MODEL NO.                        | E26                         |
| Lifting capacity                 | 6.5T                        |
| Max lifting height               | 2000mm                      |
| Min height                       | 125mm                       |
| Lifting time                     | Approx. 45S                 |
| Motor                            | 2.2kWx2                     |
| Drive-through width (Adjustable) | 2450-3150mm                 |
| Overall height                   | 3843mm                      |
| Electricity supply               | According To Customer Needs |

\* Max. Lifting height is measured with adjustable screw pads in highest position.  
 \* Machine shown with optional equipment. Actual product appearance may differ.



E26

INDEPENDENT TWO COLUMN LIFT

- Rated Capacity 6500kg, suitable for most sedans, heavy-duty SUVs, pickup trucks and vans.
- Wireless synchronized hydraulic control system, capable of correcting height variations of 50mm or less during lifting cycles.
- Pure hydraulic drive, no mechanical lifting element likes chains or steel wires. No maintenance and safety concerns associated with chains or steel cables.
- Flexible installation width to accommodate various vehicle sizes and installation spaces, recommended range: 2827–3527 mm.
- M-Arms provide extensive wheelbase compatibility
- Dual power units (2.2 kW x 2) for powerful capability, 45 seconds from bottom to top under rated load.
- Push-button control available at both columns for convenient and efficient operation.
- 3.5-inch touchscreen display for system setup and real-time height monitoring.
- APS control enables direct downward movement with safety lock disengaged.
- The latch monitoring device determines lowering logic (whether to lower directly or raise first before lowering) .
- Low-position stop and audible alarm for final travel below the stop position. No rail guards on the lift arms.
- Automatic engaging and disengaging swing arm locking device. Engage when raised and disengage at the lowest position.
- Pre-fixed hydraulic pressure prevents overloading.
- 24V Safe Control System prevents electric shock.
- Dual safety against hydraulic leakage through mechanical latch and anti- burst hydraulic valve.



Intelligent Control System

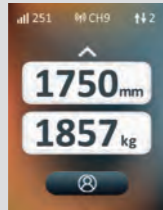

HMI Screen (Optional Load Display)



Control Panel



Height Limit Switch and Displacement Sensor

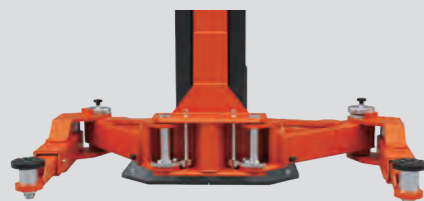

M arms

Wireless | Independent Columns | HMI Screen | CE  
Easy and Convenient | No Steel Ropes

# QUIKMULTI



E28



E28  
Type M Arms (Optional)



## E28

### INDEPENDENT TWO COLUMN LIFT

- With the maximum capacity being up to 8.0T, it is especially suitable for lifting large Pick-ups, MPVs, Vans, medium buses and loaded vehicles.
- Each column has an independent control and hydraulic power unit which provides adequate power for fast lifting and make it able to control at either side.
- HMI screen for setting networks and displaying crucial parameters.
- No interconnected ropes, hoses or wires between the two posts provides a free and unobstructed working space.
- Latch Detecting Device, decide the movement through judging the status of the latch. Necessary for efficient parking at an expected height for chassis maintenance, transmission repair or changing.
- Synchronization is automatically achieved by wireless communication technology and deviation is only allowed within a safe range.
- Pure hydraulic drive, no lifting elements like lead screws, chains or wire ropes. Less maintenance cost in the long run.
- Less installation work and more adaptable to various spaces.
- Standard flexible three stage arms.
- Detecting device to identify the engagement and disengagement of the mechanical locking unit.
- Optional type-M arms to pick up from the Smart to the long wheelbase MPVs and Vans.



Intelligent Control System

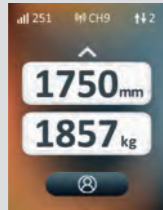

HMI Screen  
(Optional Load Display)



Control Panel



Height Limit Switch and  
Displacement Sensor



Four 3-Stage Arms

### OVERALL DIMENSION

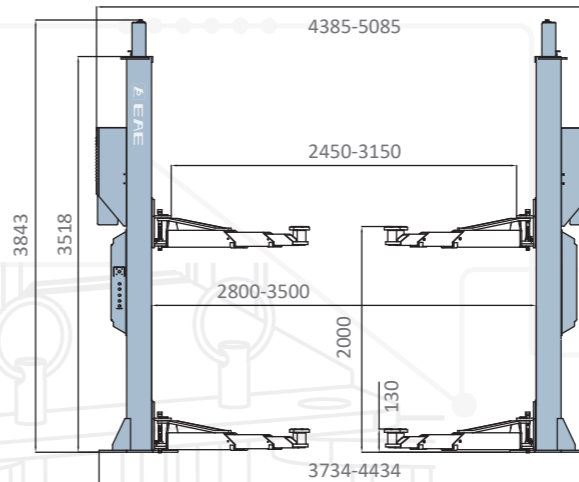

E28

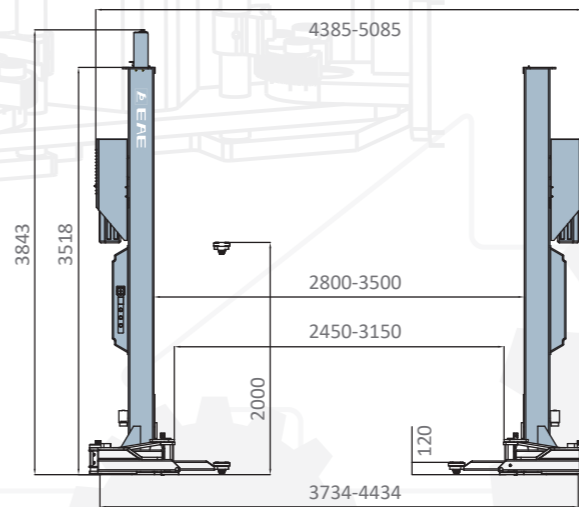
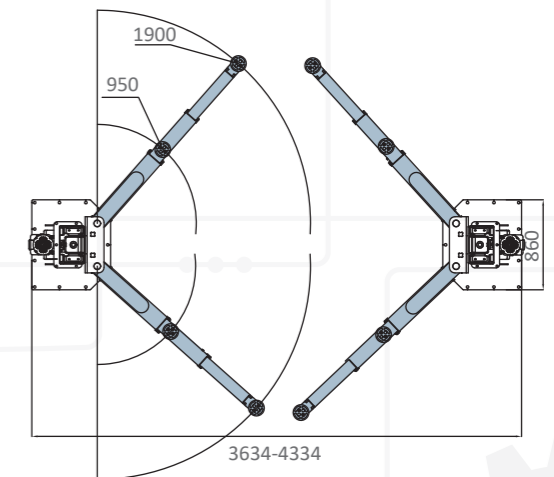

E28  
Type M Arms

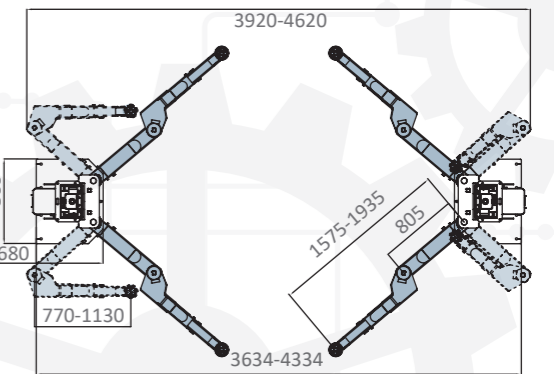

\*The dimension schemes above illustrate the optimally designed column spacing. This spacing can be reduced based on available space constraints and vehicle models when necessary.

### TECHNICAL DATA

| MODEL NO.                        | E28                         |
|----------------------------------|-----------------------------|
| Lifting capacity                 | 8.0T                        |
| Max lifting height               | 2000mm                      |
| Min height                       | 130mm                       |
| Lifting time                     | Approx. 55S                 |
| Motor                            | 2.2kWx2                     |
| Drive-through width (Adjustable) | 2450-3150mm                 |
| Overall height                   | 3843mm                      |
| Electricity supply               | According To Customer Needs |



\* Max. Lifting height is measured with adjustable screw pads in highest position.  
\* Machine shown with optional equipment. Actual product appearance may differ.

4.2T  
Lifting Capacity

APS  
Accurate Parking System

Asymmetric or Symmetric  
Column Configuration



Symmetric



Asymmetric



# 62C

## ELECTRICAL RELEASE TWO-POST LIFT

- Two-position adjustable height: 3867mm/4230mm.
- With APS technology.
- Button control, easy and convenient.
- No additional spare parts are required, it can be installed symmetrically or asymmetrically, and the total height can also be adjusted.
- The arm locks engage and disengage automatically.
- Safety is double guaranteed both by mechanical latches and restrictive valves.
- Pre-fixed hydraulic pressure prevents overloading.
- Standard aluminum motor, no risks of overheating and longer service life.
- 24V safe control system.
- Vehicle roof protective device.
- Standard door protection pads to prevent possible damage to the door opened without caution.



### Accurate Parking System

Abbreviated as APS, it enables to efficiently park the lifted vehicle at exact height which is necessary for chassis maintenance, transmission repair or changing. Without this APS system, it is hard and also time-consuming to park exactly as each time you lower the vehicle, the carriage of the lift will rise to release the mechanical safety catch.

### OVERALL DIMENSION

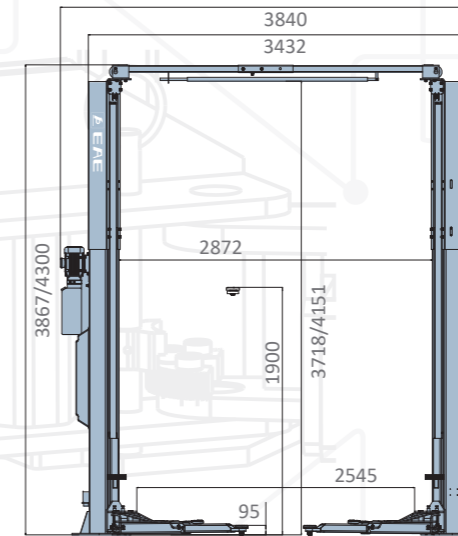

Asymmetric

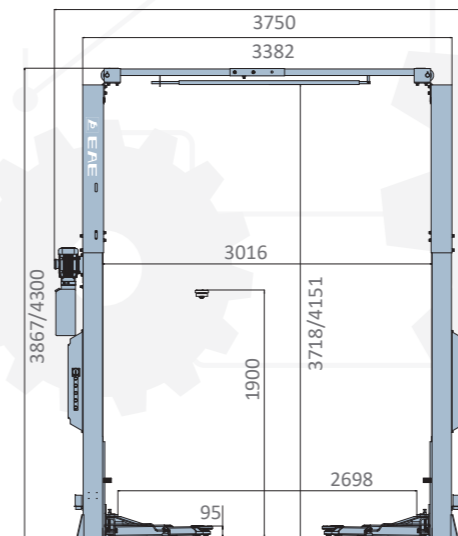
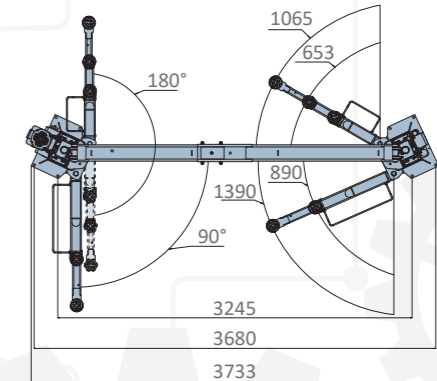

Symmetric

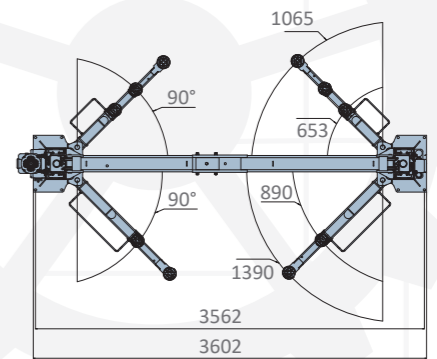

### TECHNICAL DATA

| MODEL NO.           | 62C-35T/62C-42T             |             |
|---------------------|-----------------------------|-------------|
| Lifting capacity    | 3.5T/4.2T                   |             |
| Structure Type      | Asymmetric                  | Symmetric   |
| Max. lifting height | 1900mm                      | 1900mm      |
| Min height          | 95mm                        | 95mm        |
| Drive-through width | 2545mm                      | 2698mm      |
| Lifting time        | Approx. 35S                 | Approx. 35S |
| Motor               | 3.5kW/3ph                   | 3.5kW/3ph   |
| Electricity supply  | According To Customer Needs |             |

\* Maximum lifting height is measured with threaded adapters fully extended.  
\* Depicted configuration includes optional equipment; actual product may vary.



24 Control Box



Auxiliary Control (Optional)

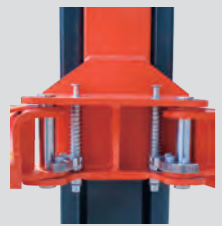

Strong Carriage and Arm Structure



Aluminum Motor



3-Stage Short Arm And 2-Stage Long Arm

4.5T  
Lifting Capacity

Adjustable  
Column Height

Asymmetric or Symmetric  
Column Configuration



Symmetric



Asymmetric



# 62C

## ELECTRICAL RELEASE TWO-POST LIFT

- Two-position adjustable height: 3847mm/4285mm.
- Ready to install symmetrically or asymmetrically without requiring any additional parts.
- Standard Arm: 3-stage straight short arms+ 2-stage straight long arms.  
Optional M-Arms provide unlimited wheelbase compatibility.
- Aluminum Shell Motor: Rapid dissipation, consistent efficiency.
- Push-button control for easier operation.  
An optional secondary control box to enable dual-side operation
- APS Control enables lowering to the expected height on the first try, eliminating repeated adjustments.
- The latch monitoring device determines whether to lower directly or raise first before lowering.
- Low-position stop and audible alarm for final travel below the stop position.
- Automatic engaging and disengaging swing arm locking device. Engage when raised and disengage at the lowest position.
- Pre-fixed hydraulic pressure prevents overloading.
- 24V Safe Control System and a sealed ABS enclosure to prevent electric shock, moisture damage, and electrical leakage.
- Roof protective switch prevents interference with the lift crossbeam.
- Dual safety against hydraulic leakage through mechanical latch and anti- burst hydraulic valve.



24 Control Box



Auxiliary Control (Optional)

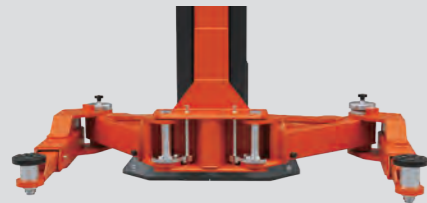

M arms (Optional)



3-Stage Short Arm And 2-Stage Long Arm



### Accurate Parking System

Abbreviated as APS, it enables to efficiently park the lifted vehicle at exact height which is necessary for chassis maintenance, transmission repair or changing. Without this APS system, it is hard and also time-consuming to park exactly as each time you lower the vehicle, the carriage of the lift will rise to release the mechanical safety catch.

### OVERALL DIMENSION

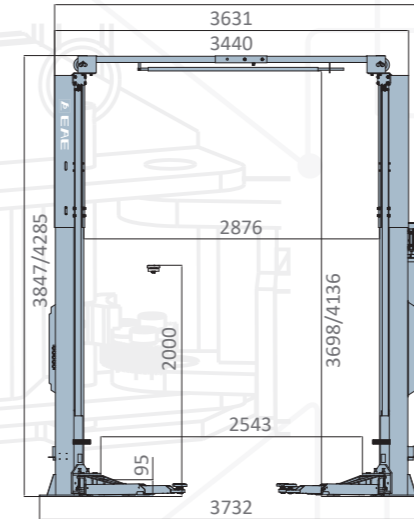

Asymmetric

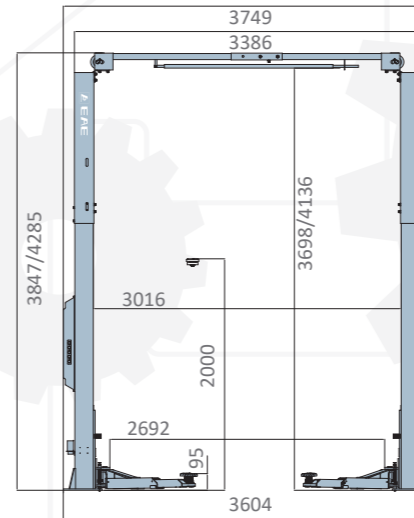
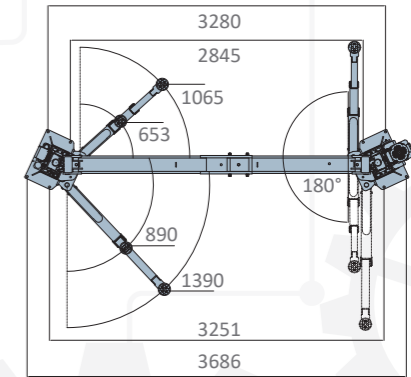

Symmetric

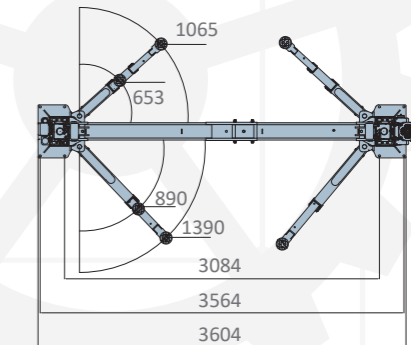

### TECHNICAL DATA

| MODEL NO.           | 62C-45T                     |             |
|---------------------|-----------------------------|-------------|
| Lifting capacity    | 4.5T                        |             |
| Structure Type      | Asymmetric                  | Symmetric   |
| Max. lifting height | 2000mm                      | 2000mm      |
| Min height          | 95mm                        | 95mm        |
| Drive-through width | 2543mm                      | 2692mm      |
| Lifting time        | Approx. 35S                 | Approx. 35S |
| Motor               | 3.5kW/3ph                   | 3.5kW/3ph   |
| Electricity supply  | According To Customer Needs |             |

\* Maximum lifting height is measured with threaded adapters fully extended.  
 \* Depicted configuration includes optional equipment; actual product may vary.

**6.0T**  
Max. Capacity

**APS**  
Accurate Parking System  
Technology By EAE

**2000MM**  
Max. Lifting Height  
with Standard SUV Adapters



**Accurate Parking System**

Abbreviated as APS, it enables to efficiently park the lifted vehicle at exact height which is necessary for chassis maintenance, transmission repair or changing. Without this APS system, it is hard and also time-consuming to park exactly as each time you lower the vehicle, the carriage of the lift will rise to release the mechanical safety catch.



62C-50T



62C-60T



**62C**

**ELECTRICAL RELEASE TWO-POST LIFT**

- Clear floor design for easy movement of maintenance equipment under the raised vehicle.
- With APS technology.
- 1900mm lifting height.
- 5.0T/6.0T lifting capacity.
- Durable cylinders in each column carry with anti-surge valves.
- Screw-up lifting pads with clearance height less than 110mm.
- The arm locks engage and disengage automatically.
- More flexible three stage arms.
- Vehicle roof protective device.
- Standard aluminum motor avoids overheating and ensures long service life.
- Durable powder coating.
- Standard door protection pads to prevent possible damage when open the door without caution.
- Standard column curtain.
- Pre-fixed hydraulic pressure prevents overloading operation.
- ABS control box with rubber gasket sealing.
- CE certificated.

**OVERALL DIMENSION**

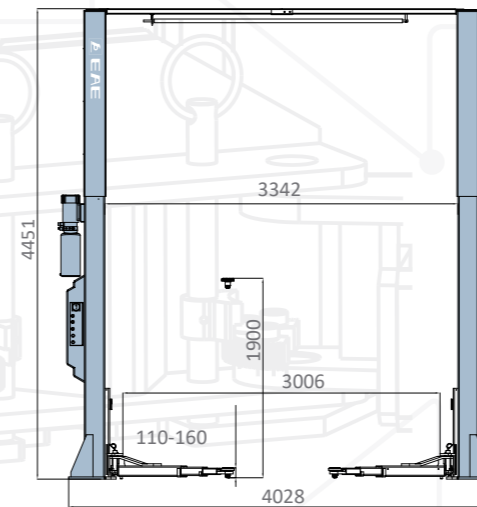

62C-50T

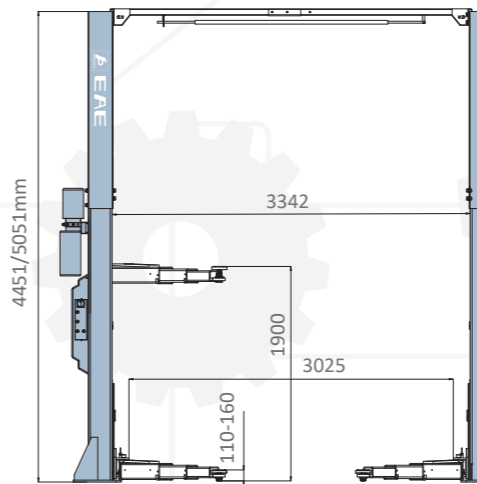
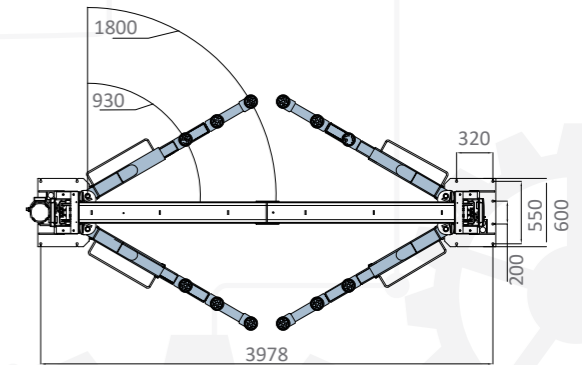

62C-60T

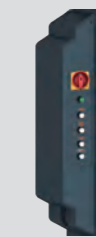
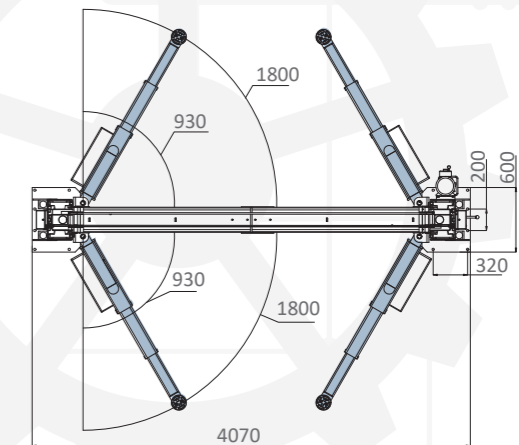

24 Control Box



Aluminum Motor



Three Stage Short Arm

**TECHNICAL DATA**

| MODEL NO.           | 62C-50T                     | 62C-60T     |
|---------------------|-----------------------------|-------------|
| Lifting capacity    | 5.0T                        | 6.0T        |
| Max. lifting height | 1900mm                      | 1900mm      |
| Overall height      | 4451mm                      | 4451/5051mm |
| Min. height         | 110mm                       | 110mm       |
| Drive-through width | 3006mm                      | 3025mm      |
| Lifting time        | Approx. 35S                 | Approx. 55S |
| Motor               | 3.5kW/3ph                   | 3.5kW/3ph   |
| Electricity supply  | According To Customer Needs |             |

\* Maximum lifting height is measured with threaded adapters fully extended.  
\* Depicted configuration includes optional equipment; actual product may vary.



**5.0T**  
Max. Capacity

**APS**  
Accurate Parking System  
Technology By EAE

**2000MM**  
Max. Lifting Height  
with Standard SUV Adapters



**Accurate Parking System**

Abbreviated as APS, it enables to efficiently park the lifted vehicle at exact height which is necessary for chassis maintenance, transmission repair or changing. Without this APS system, it is hard and also time-consuming to park exactly as each time you lower the vehicle, the carriage of the lift will rise to release the mechanical safety catch.



62B-35T/42T



62B-50T



**62B**

**ELECTRICAL RELEASE TWO-POST LIFT**

- Base Plate type for low ceiling workshops and garages.
- With APS technology.
- 1900mm lifting height.
- 3.5T/4.2T/5.0T lifting capacity.
- Durable cylinders in each column carry with anti-surge valves.
- Screw-up lifting pads with clearance height less than 95mm.
- 3-stage short arm and 2-stage long arm. (62B-35T/62B-42T)
- More flexible three stage arms.(62B-50T)
- The arm locks engage and disengage automatically.
- Standard aluminum motor avoids overheating and ensures long service life.
- Durable powder coating.
- Standard door protection pads to prevent possible damage when open the door without caution.
- Standard column curtain.
- Pre-fixed hydraulic pressure prevents overloading operation.
- ABS control box with rubber gasket sealing.
- CE certificated.

**OVERALL DIMENSION**

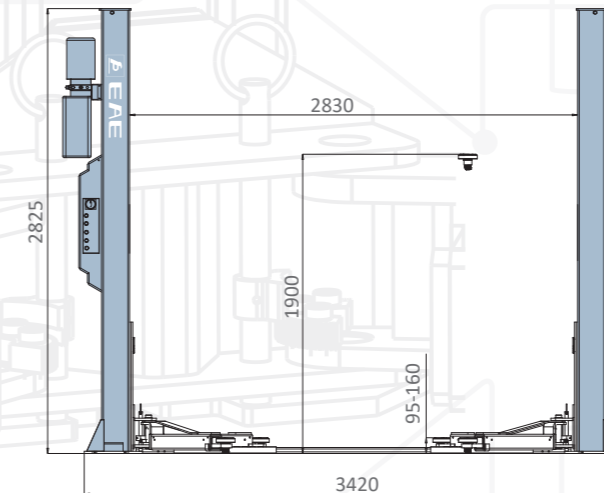

62B-35T/42T

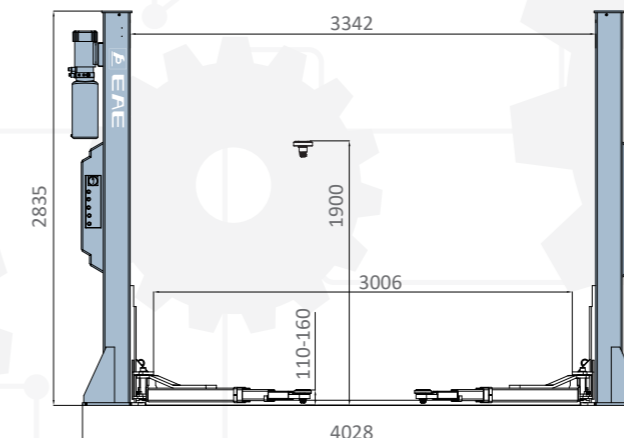
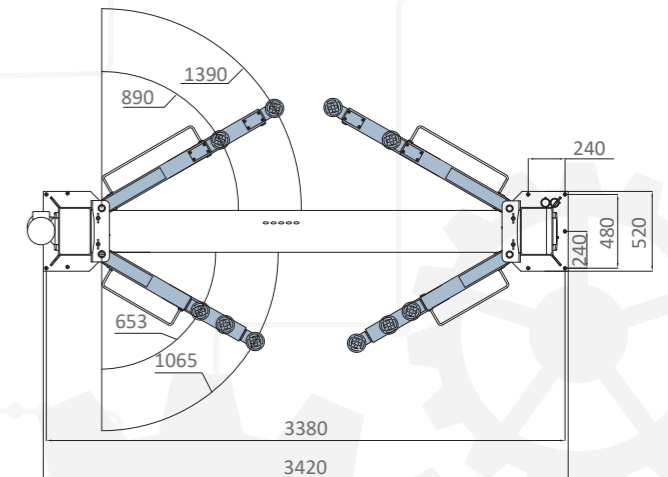

62B-50T

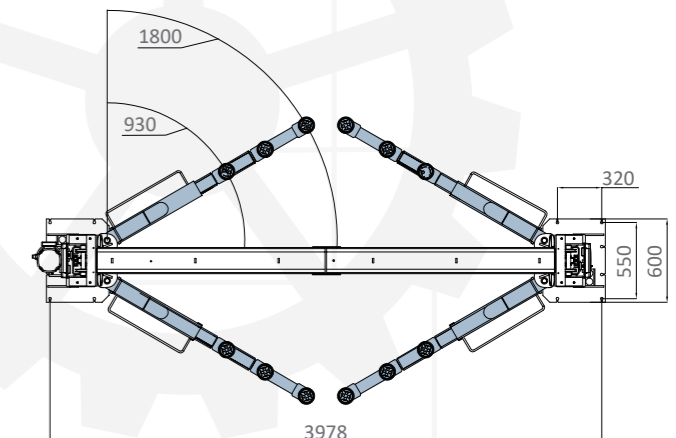

**TECHNICAL DATA**

| MODEL NO.           | 62B-35T/62B-42T             | 62B-50T     |
|---------------------|-----------------------------|-------------|
| Lifting capacity    | 3.5T/4.2T                   | 5.0T        |
| Max. lifting height | 1900mm                      | 1900mm      |
| Overall height      | 2825mm                      | 2835mm      |
| Min. height         | 95mm                        | 110mm       |
| Drive-through width | 2558mm                      | 3006mm      |
| Lifting time        | Approx. 35S                 | Approx. 45S |
| Motor               | 3.5kW/3ph                   | 3.5kW/3ph   |
| Electricity supply  | According To Customer Needs |             |

\* Maximum lifting height is measured with threaded adapters fully extended.  
\* Depicted configuration includes optional equipment; actual product may vary.

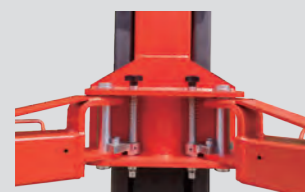

Strong Carriage and Arm Structure



24 Control Box



Chain support with derailment protection



Round Screw-up Lifting Pad



3-Stage Short Arm And 2-Stage Long Arm(62B 3.5T/4.2T)

**3.5T/4.2T**  
Lifting Capacity

Simply Pull Down One Handle  
For Lowering



C9M/C10M



## C9M/C10M

### SINGLE-SIDE MANUAL RELEASE TWO-POST LIFT

- Clear floor design for easy movement of maintenance equipment under the raised vehicle.
- Two-position adjustable height: 3600mm/3900mm. No extra parts are required for adjustment.
- One-handle lowering control.
- Chain-free, direct cylinder drive minimizes wear parts, lowering maintenance costs.
- The arm locks engage and disengage automatically.
- Users' safety is double guaranteed by using both mechanical latches and restrictive valves.
- Durable cylinders in each column with anti-surge valves.
- With vehicle roof protection. The power system switches off when vehicle roof touches the rubber protected overhead bar.
- Pre-fixed hydraulic pressure prevents overloading operation.
- Standard column curtain.
- 24V safe control system.
- 3-stage short arm and 2-stage long arm.

### OVERALL DIMENSION

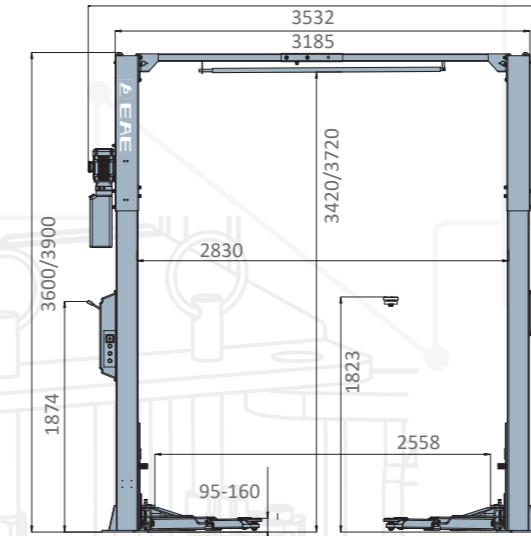

C9M

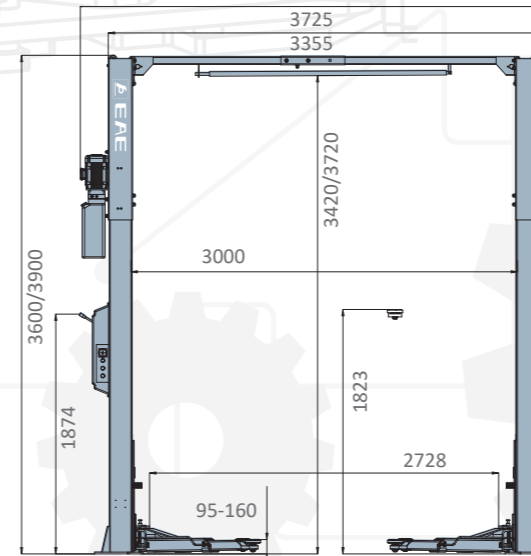
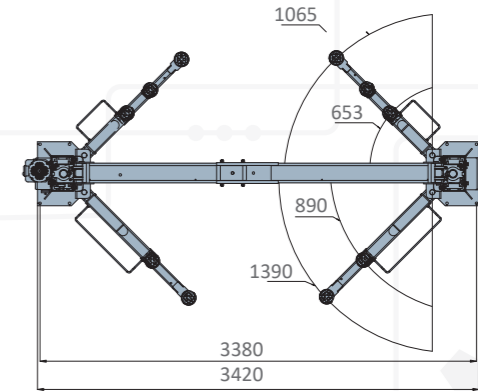

C10M

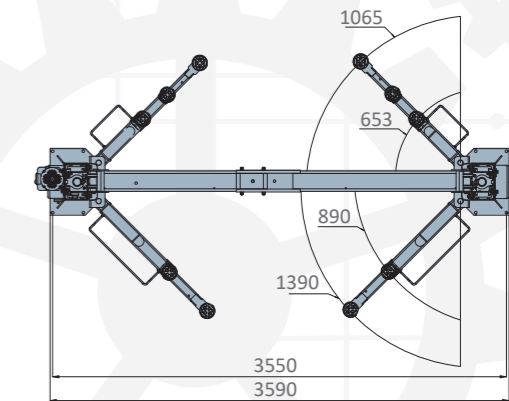

### TECHNICAL DATA

| MODEL NO.           | C9M                         | C10M       |
|---------------------|-----------------------------|------------|
| Lifting capacity    | 3.5T                        | 4.2T       |
| Max. lifting height | 1823mm                      | 1823mm     |
| Min. height         | 95mm-160mm                  | 95mm-160mm |
| Lifting time        | Approx.55S                  | Approx.55S |
| Motor               | 2.2kW                       | 2.2kW      |
| Drive-through width | 2558mm                      | 2728mm     |
| Overall width       | 3420mm                      | 3590mm     |
| Inside Column       | 2830mm                      | 3000mm     |
| Electricity supply  | According To Customer Needs |            |

\* Maximum lifting height is measured with threaded adapters fully extended.  
\* Depicted configuration includes optional equipment; actual product may vary.



Handle for Release & Descent

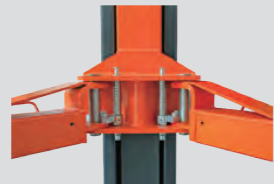

Strong Carriage and Arm Structure



Easier for making both sides work synchronously



Aluminum Motor



3-Stage Short Arm And 2-Stage Long Arm

**4.0T/4.5T/5.5T** | Simply Pull Down One Handle |  
Lifting Capacity For Lowering



C9Z/C10Z



C12  
Asymmetric or Symmetric



# C9Z/C10Z/C12

## SINGLE-SIDE MANUAL RELEASE TWO-POST LIFT

- 4.0T/4.5T/5.5T lifting capacity.
- One-handle lowering control.
- Single side mechanical lock release.
- Chain-free, direct cylinder drive minimizes wear parts, lowering maintenance costs.
- The arm locks engage and disengage automatically.
- Users' safety is double guaranteed by using both mechanical latches and restrictive valves.
- Durable cylinders in each column with anti-surge valves.
- With vehicle roof protection. The power system switches off when vehicle roof touches the rubber protected overhead bar.
- Standard door protection pads to prevent possible damage to the door opened without caution.
- Pre-fixed hydraulic pressure prevents overloading operation.
- Standard chain protection curtain.
- 3-stage short arm and 2-stage long arm. (C9Z/C10Z)
- More Flexible Three Stage Arms. (C12)

### OVERALL DIMENSION

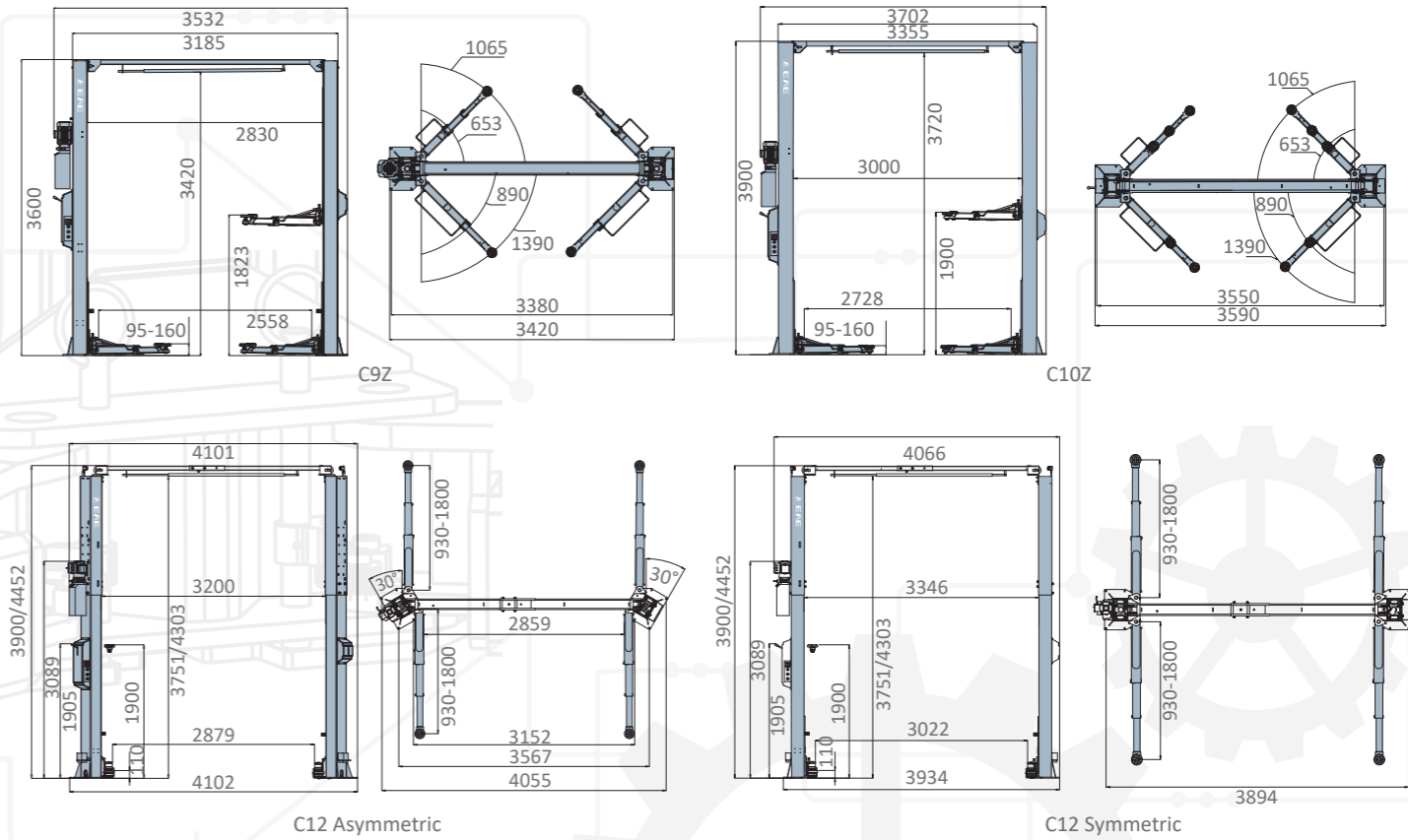

### TECHNICAL DATA

| MODEL NO.           | C9Z                         | C10Z       | C12 Asymmetric | C12 Symmetric |
|---------------------|-----------------------------|------------|----------------|---------------|
| Lifting capacity    | 4.0T                        | 4.5T       | 5.5T           | 5.5T          |
| Max lifting height  | 1823mm                      | 1900mm     | 1900mm         | 1900mm        |
| Min height          | 95mm                        | 95mm       | 110mm          | 110mm         |
| Lifting time        | Approx.55S                  | Approx.55S | Approx.55S     | Approx.55S    |
| Capacity of motor   | 2.2kW                       | 2.2kW      | 2.2kW          | 2.2kW         |
| Overall Height      | 3600mm                      | 3900mm     | 3900/4452mm    | 3900/4452mm   |
| Drive through width | 2558mm                      | 2728mm     | 2879mm         | 3022mm        |
| Electricity supply  | According To Customer Needs |            |                |               |

\* Maximum lifting height is measured with threaded adapters fully extended.  
\* Depicted configuration includes optional equipment; actual product may vary.



Handle for Release & Descent

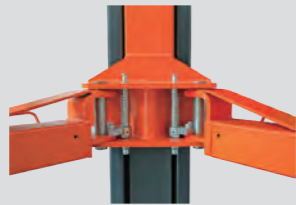

Strong Carriage and Arm Structure



3-Stage Short Arm And 2-Stage Long Arm (C9Z/C10Z)



3.5T/4.2T  
Lifting Capacity

Simply Pull Down One Handle  
For Lowering



**OVERALL DIMENSION**

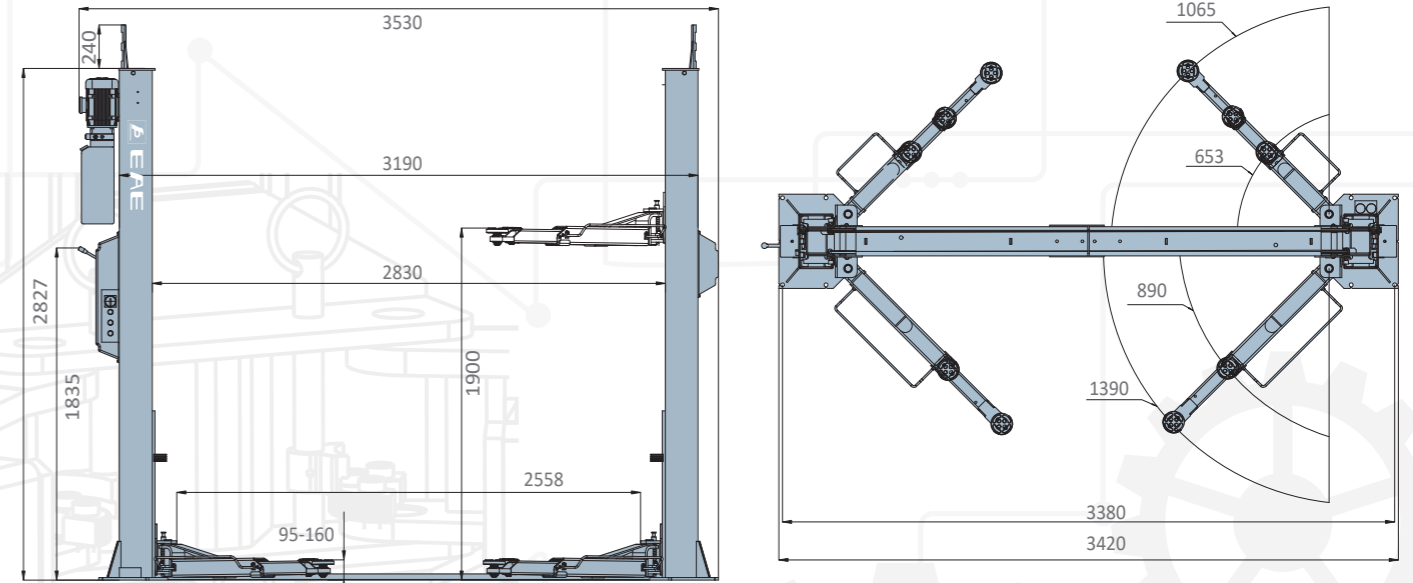

F9M/F10M

**TECHNICAL DATA**

| MODEL NO.           | F9M/F10M                    |
|---------------------|-----------------------------|
| Lifting capacity    | 3.5T/4.2T                   |
| Max. lifting height | 1900mm                      |
| Min. height         | 95mm-160mm                  |
| Lifting time        | Approx.55S                  |
| Capacity of motor   | 2.2kW                       |
| Overall Height      | 2827mm+240mm                |
| Drive through width | 2558mm                      |
| Electricity supply  | According To Customer Needs |

\* Maximum lifting height is measured with threaded adapters fully extended.  
\* Depicted configuration includes optional equipment; actual product may vary.



**F9M/F10M**

**SINGLE-SIDE MANUAL RELEASE TWO-POST LIFT**

- Simply push one button to engage the mechanical safety locking unit.
- Durable cylinders in each column with anti-surge valves.
- Standard door protection pads to prevent possible damage to the door opened without caution.
- Pre-fixed hydraulic pressure prevents overloading operation.
- Standard column curtain.
- 24V safe control system.
- 3-stage short arm and 2-stage long arm.



Handle for Release & Descent



Strong Carriage and Arm Structure



Aluminum Motor



Round Screw-up Lifting Pad



3-Stage Short Arm And 2-Stage Long Arm

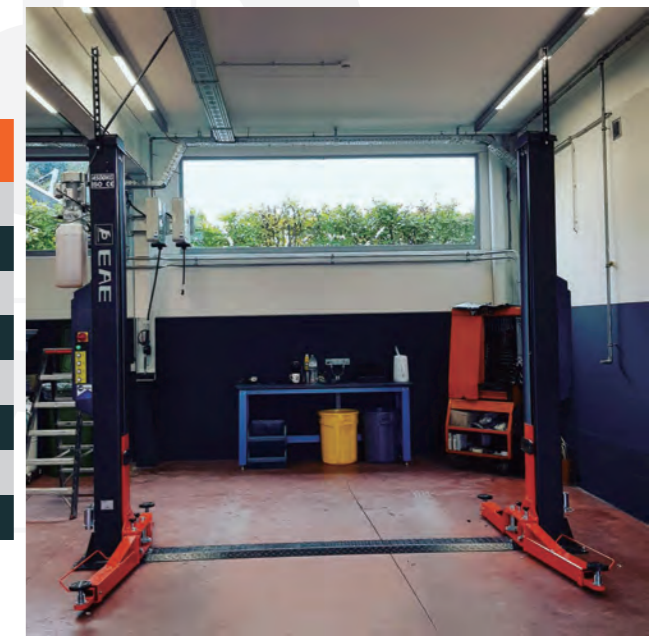

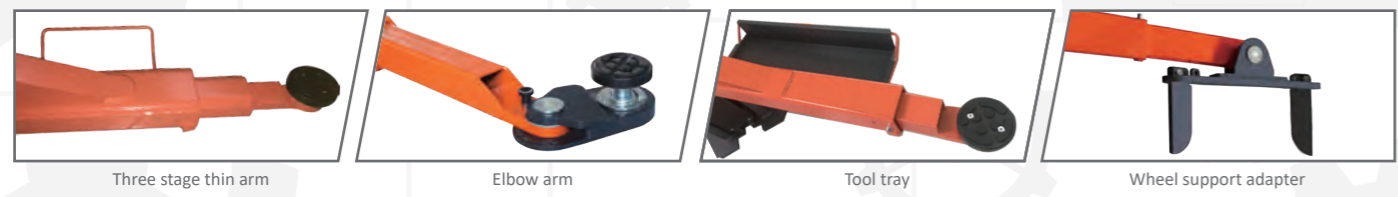

| SERIES  | Structure Type | E                   |                           | F                         |                            | C                         |                            | 62BE                       |                            | 62CE                       |                            |             |             |             |             |
|---|----------------|---------------------|---------------------------|---------------------------|----------------------------|---------------------------|----------------------------|----------------------------|----------------------------|----------------------------|----------------------------|-------------|-------------|-------------|-------------|
|   |                | Independent Columns | Baseplate/Manual/One Side | Baseplate/Manual/One Side | Clearfloor/Manual/One Side | Baseplate/Manual/One Side | Clearfloor/Manual/One Side | Clearfloor/Manual/One Side | Clearfloor/Manual/One Side | Clearfloor/Manual/One Side | Clearfloor/Manual/One Side |             |             |             |             |
| MODEL NO.   | E25            | E26                 | E28                       | F9M                       | F10M                       | CSZ                       | C9M                        | C10Z                       | C10M                       | C12                        | 62C.35T                    | 62C.42T     | 62C.45T     | 62C.50T     | 62C.60T     |
| Lifting Capacity (T)  | 5.0            | 6.5                 | 8.0                       | 3.5                       | 4.2                        | 4.0                       | 3.5                        | 4.5                        | 4.2                        | 5.5                        | 3.5                        | 4.2         | 4.5         | 5.0         | 6.0         |
| CE CERTIFICATION  | CE             | CE                  | CE                        | CE                        | CE                         | CE                        | CE                         | CE                         | CE                         | CE                         | CE                         | CE          | CE          | CE          | CE          |
| LOCK RELEASE (E-Electrical M-Manual O-One side)                           | E              | E                   | E                         | M                         | M                          | M                         | M                          | M                          | M                          | M                          | E                          | E           | E           | E           | E           |
| APS (Accurate parking system)   |                |                     |                           |                           |                            |                           |                            |                            |                            |                            |                            |             |             |             |             |
| Motor   | 3.5KW          | 3.5KW               | 2.2KW                     | 2.2KW                     | 2.2KW                      | 2.2KW                     | 2.2KW                      | 2.2KW                      | 2.2KW                      | 2.2W                       | 3.5KW                      | 3.5KW       | 3.5KW       | 3.5KW       | 3.5KW       |
| 2-stage long arm (mm)   |                |                     |                           | 890-1390                  | 890-1390                   | 890-1390                  | 890-1390                   | 890-1390                   | 890-1390                   | 890-1390                   | 890-1390                   | 890-1390    | 890-1390    | 890-1390    | 890-1390    |
| 3-stage short (mm)  |                |                     |                           | 653-1065                  | 653-1065                   | 653-1065                  | 653-1065                   | 653-1065                   | 653-1065                   | 653-1065                   | 653-1065                   | 653-1065    | 653-1065    | 653-1065    | 653-1065    |
| Four Three Stage Arm(mm)  |                |                     |                           | 930-1800                  | 930-1800                   | 930-1800                  | 930-1800                   | 930-1800                   | 930-1800                   | 930-1800                   | 930-1800                   | 930-1800    | 930-1800    | 930-1800    | 930-1800    |
| Type M Arm(mm)  | 743-1073       | 770-1130            | 770-1130                  | 1470-1800                 | 1575-1953                  | 1575-1953                 |                            |                            |                            |                            |                            |             |             |             |             |
| Overall Height (mm)   | 2912           | 3518-325            | 3518+325                  | 2827+240                  | 2827+240                   | 3600                      | 3600/3900                  | 3900                       | 3600/3900                  | 3900/4452                  | 2825                       | 2825        | 2825        | 2835        | 2835        |
| Max. Lifting Height (mm) (With adjustable screw pads in highest position) | 2000           | 2000                | 2000                      | 1900                      | 1900                       | 1823                      | 1823                       | 1900                       | 1823                       | 1900                       | 1900                       | 1900        | 1900        | 1900        | 1900        |
| Min. Lifting Height (mm) (With adjustable screw pads in lowest position)  | 110            | 125                 | 130                       | 95                        | 95                         | 95                        | 95                         | 95                         | 95                         | 110                        | 95                         | 95          | 95          | 110         | 110         |
| Thin arm 85mm Min. Lifting Height   |                |                     |                           |                           |                            |                           |                            |                            |                            |                            |                            |             |             |             |             |
| Overall Width (mm)  | 4188           | 4237                | 4434                      | 3420                      | 3420                       | 3420                      | 3420                       | 3590                       | 4055/3894                  | 3420                       | 3420                       | 3602/3733   | 3602/3733   | 3604/3686   | 4070        |
| Inside Column (mm)  | 3500           | 3527                | 3500                      | 2830                      | 2830                       | 2830                      | 2830                       | 3000                       | 3200/3346                  | 2830                       | 2830                       | 3016/2872   | 3016/2872   | 3016/2876   | 3342        |
| Drive through (mm)  | 3130           | 3150                | 3150                      | 2558                      | 2558                       | 2558                      | 2558                       | 2728                       | 2879/3022                  | 2558                       | 2558                       | 2698/2545   | 2698/2545   | 2697/2543   | 3006        |
| lifting Time (s)  | Approx. 25S    | Approx. 45S         | Approx. 55S               | Approx. 55S               | Approx. 55S                | Approx. 55S               | Approx. 55S                | Approx. 55S                | Approx. 55S                | Approx. 55S                | Approx. 35S                | Approx. 35S | Approx. 35S | Approx. 35S | Approx. 55S |
| Wheel support adapter   |                |                     |                           |                           |                            |                           |                            |                            |                            |                            |                            |             |             |             |             |
| Elbow Arm   |                |                     |                           |                           |                            |                           |                            |                            |                            |                            |                            |             |             |             |             |
| Auxiliary Control   |                |                     |                           |                           |                            |                           |                            |                            |                            |                            |                            |             |             |             |             |
| Power/Supply  |                |                     |                           |                           |                            |                           |                            |                            |                            |                            |                            |             |             |             |             |

Recommend Supply 110/220/240/380/415V (1/3 Phase) According to Customer Needs

• Standard • Optional

**6.5T**  
Max. Capacity

**6028MM**  
Max. Platform Length

User friendly  
Electrical Lock Release



6435B



# 6435S/B

## FOUR POST LIFT

- Reliable mechanical safety locking system.
- Avoid rapid descending caused by leakages of hydraulic system by applying FLOW-CONTROL technique.
- The max. height switch limits the travel of runways and ensures cylinders work within the stroke.
- Protect against pinching and shearing using alarming buzzer in descending process.
- 24V safety control voltage.
- Reliable electrical release for easy and efficient use. (E version)
- Adjustable PD positions can accommodate different types of vehicle.
- Compact quick plug for electrical connection releases installers from too many wires and terminals and make initial installation much more efficient. Save more than 70% time on wire connection.
- Low profile runway is convenient for driving on and off and less demanding on space.
- The width between the platform can be adjust to 1150, 1025, 970, 915mm when installing.

## OVERALL DIMENSION

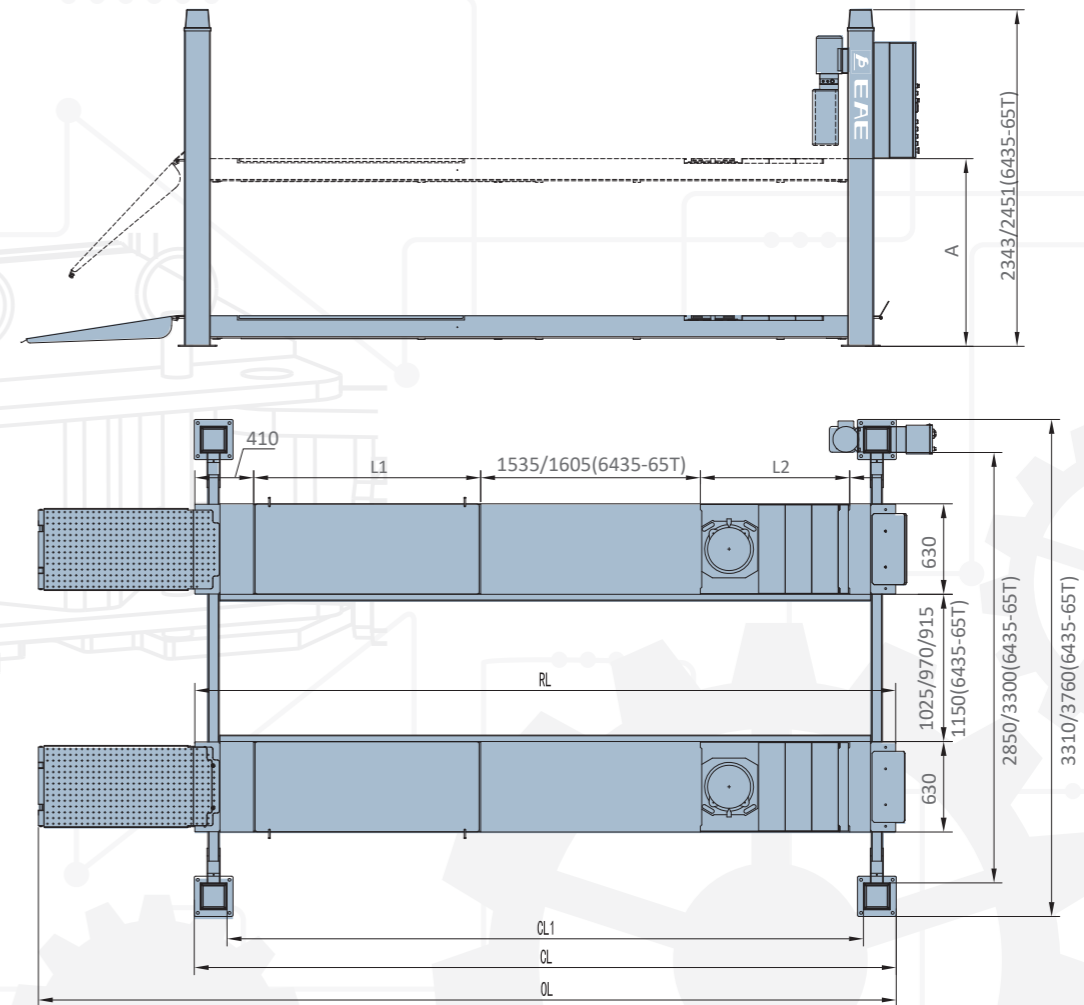

- S Flat platforms
- B Platforms with front recesses and rear slip plates
- BPD Platforms with front recesses, play detector, and rear slip plates.



## TECHNICAL DATA

| Model No.   | Lifting capacity | Max. lifting height(A) | L1   | L2   | RL   | CL1  | CL   | OL   |
|-------------|------------------|------------------------|------|------|------|------|------|------|
| 6435S-48L   | 4.0T/5.0T        | 185-1830               | N/A  | N/A  | 4880 | 4438 | 4888 | 5948 |
| 6435S-52L   |                  |                        |      |      | 5280 | 4838 | 5288 | 6348 |
| 6435S-57L   |                  |                        |      |      | 5780 | 5338 | 5788 | 6848 |
| 6435B-48L   | 4.0T/5.0T        | 185-1830               | 1580 | 1140 | 4880 | 4438 | 4888 | 5948 |
| 6435B-52L   |                  |                        | 1980 |      | 5280 | 4838 | 5288 | 6348 |
| 6435B-57L   |                  |                        | 2280 |      | 5780 | 5338 | 5788 | 6848 |
| 6435BPD-48L | 4.0T/5.0T        | 185-1830               | 1580 | 1140 | 4880 | 4438 | 4888 | 5948 |
| 6435BPD-52L |                  |                        | 1980 |      | 5280 | 4838 | 5288 | 6348 |
| 6435BPD-57L |                  |                        | 2280 |      | 5780 | 5338 | 5788 | 6848 |
| 6435S-65T   | 6.5T             | 212-1830               | 2280 | 1370 | 6000 | 5540 | 6028 | 7300 |
| 6435B-65T   |                  | 262-1850               |      |      |      |      |      |      |

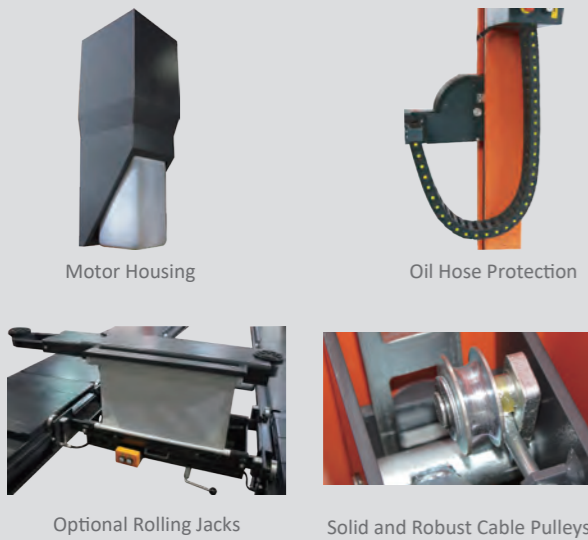

Motor Housing

Oil Hose Protection

Optional Rolling Jacks

Solid and Robust Cable Pulleys



5.0T Max. Capacity | 3000MM Between Columns for 3D Aligning | Wheel Free Lift Standard 4.0T | **CE**



**OVERALL DIMENSION**

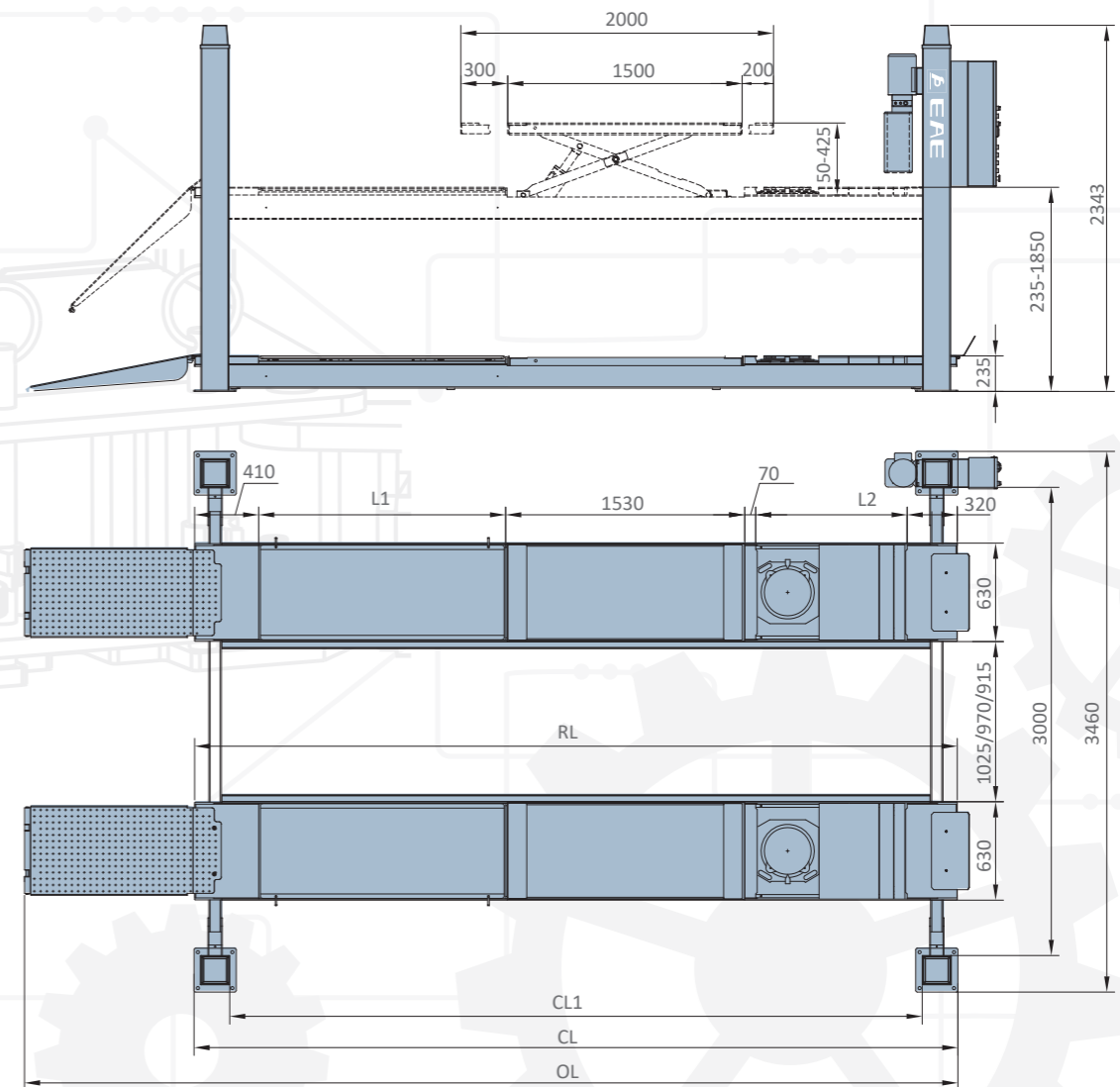

FOUR POST LIFT



**6435BWF**

**FOUR POST LIFT**

- 4.0T/5.0T lifting capacity.
- Built-in wheel free jack has a max capacity of 4000kg and is extendable in length.
- Long slip plate and adjustable turntable positions accommodate different kinds of wheelbases.
- Electrical release, just press UP and DOWN button to control the lift.
- Wide platforms for easier driving on and off.
- 3000mm distance between two columns compatible to 3D wheel aligner.
- The great planeness of runways is perfect for high accurate wheel aligning.
- Driving-on ramps with polymer rollers.
- Reserved tracks on platforms fit for optional rolling jacks.
- Low profile runway allows the vehicles drive on and off conveniently.
- 24V safe control system.
- Solid and robust cable pulleys.
- Self-lubricated bushing and bearing.
- Platforms non-synchronization alarming system.
- Safety device works immediately in case a rope slacks or fails.
- Alarm buzzer for safe descending.
- Aluminum motor with fan on top to avoid overheating caused by long time working.

**TECHNICAL DATA**

| Model No.   | Lifting capacity | Max. lifting height | L1   | L2   | RL   | CL1  | CL   | OL   |
|-------------|------------------|---------------------|------|------|------|------|------|------|
| 6435BWF-48L | 4.0T/5.0T        | 1850                | 1580 | 970  | 4880 | 4438 | 4888 | 5970 |
| 6435BWF-52L |                  |                     | 1980 |      |      | 4838 | 5288 | 6370 |
| 6435BWF-57L | 5.0T             |                     | 2280 | 1170 | 5780 | 5338 | 5788 | 6870 |



10T  
Lifting Capacity

Wireless

Open  
Front and Rear



**QUIKMULTI**



The platform length being up to 7000mm

**OVERALL DIMENSION**

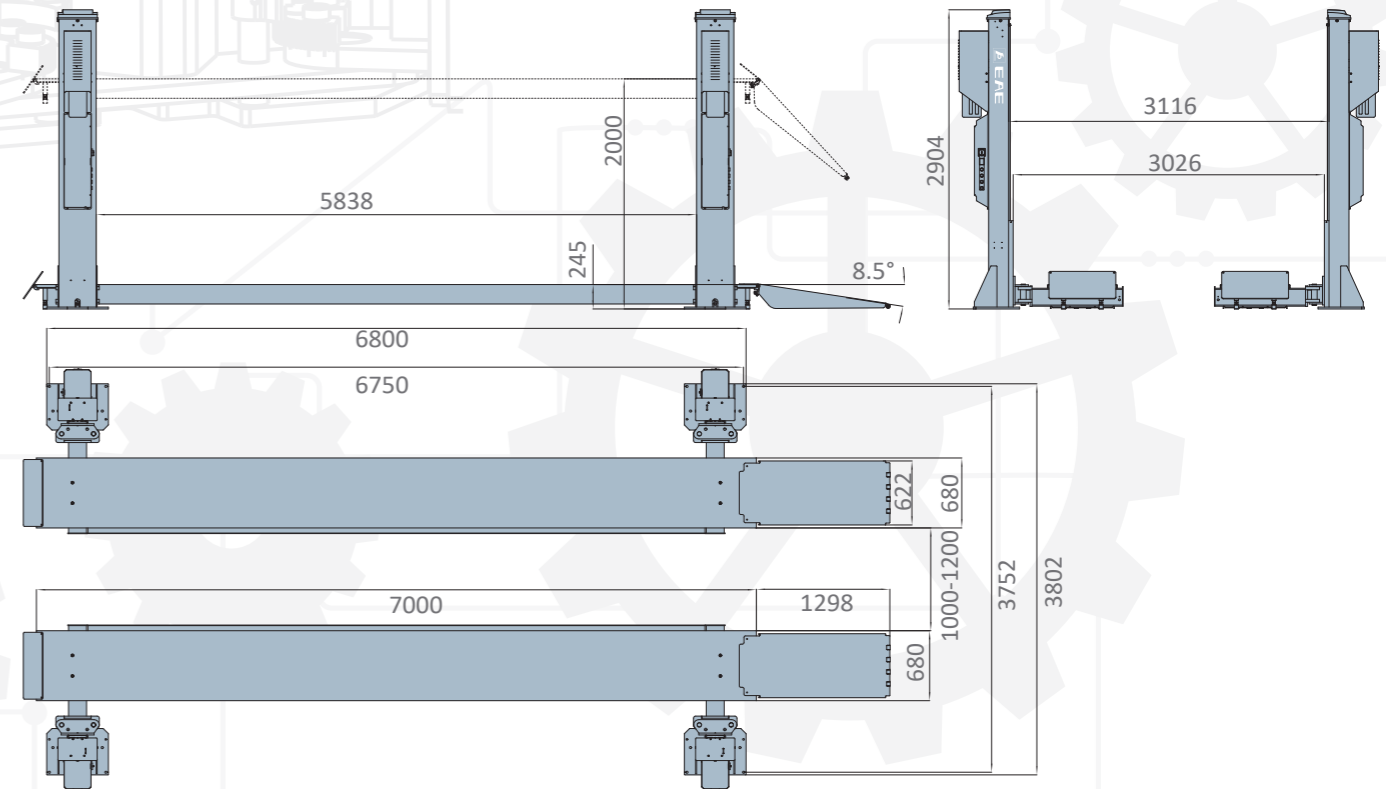

**E410S**  
**INDEPENDENT 4-POST LIFT**

- 10-ton rated capacity , 7-meter long platform, capable of lifting a wide range of vehicles, including passenger sedans, cargo vans, heavy-duty pickups, motorhomes and school buses.
- Wireless synchronized hydraulic control system , capable of correcting height variations of 50mm or less during lifting cycles.
- Hydraulic Drive, no wire ropes. Easy setup and minimal maintenance.
- Flexible installation width to accommodate various vehicle sizes and installation spaces , recommended range: 1000-1200mm
- Open-ended design without crossbeams for a totally clear work path.
- Standard rails for optional jacking beams.
- Dual power units (2.2 kW x 4) for powerful capability, 40 seconds from bottom to top under rated load.
- Push-button control available at each columns for convenient and efficient operation.
- 3.5-inch touchscreen display for system setup and real-time height monitoring.
- APS control enables direct downward movement with safety lock disengaged.
- The latch monitoring device determines lowering logic (whether to lower directly or raise first before lowering)
- Low-position stop and audible alarm for final travel below the stop position.
- Pre-fixed hydraulic pressure prevents overloading.
- 24V Safe Control System prevents electric shock.
- Dual safety against hydraulic leakage through mechanical latch and anti- burst hydraulic valve.

**TECHNICAL DATA**

| MODEL NO.           | E410S                       |
|---------------------|-----------------------------|
| Lifting capacity    | 10T                         |
| Max. lifting height | 2000mm                      |
| Min. height         | 245mm                       |
| Longer Platform     | 7000mm                      |
| Capacity of motor   | 2.2kWx4                     |
| Lifting time        | 40S                         |
| Electricity supply  | According To Customer Needs |

\* Machine shown with optional equipment. Actual product appearance may differ.



Independent and identical control panel available at each columns

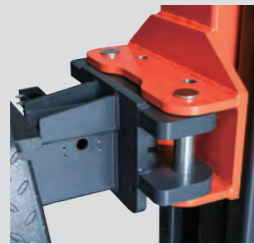

Cantilever beam



Intelligent Control System

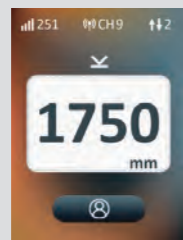

HMI Screen

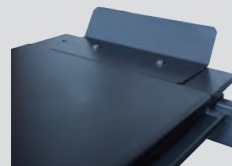

wheel stop

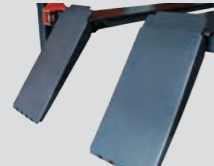

Drive-on ramp



6435BPD 4.0T/5.0T/6.5T



HX50BPD 5.0T



## Play Detector

### Features of Automobile Suspension Steering System Clearance Tester

It is convenient to check parts fit clearance of automobile suspension steering system. Make sure the front or rear wheels on top of two test boards. Manipulate the two test boards by the switches on the handheld remote control, or the PD remote-control unit, move left and right or rotate. It can easily figure out the clearance of pull rod, ball head, steering arms, wheel bearing, etc.

High quality steel, high intensity body, good brand hydraulic spare parts, stable and reliable performance. The clearance tester adopts hydraulic drive. Deck plate can move smoothly under the action of hydraulic pressure, with great displacement force. Lighting and control switch on the handheld remote control, easy to control and observe.

This product is especially suitable for monitoring station, routine inspection station in car dealerships, repair shops, etc.



FOUR POST LIFT



### Move Route of Play Detector

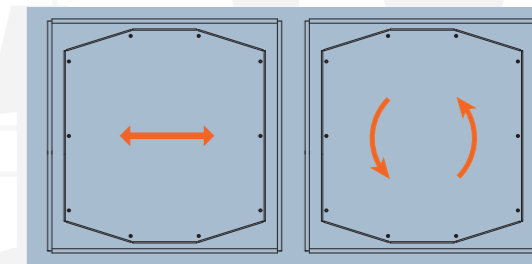

PD

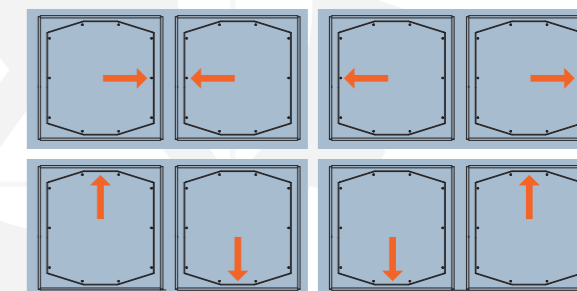

PD8

### TECHNICAL DATA

| Model NO.                            | PD                          | PD8        |
|--------------------------------------|-----------------------------|------------|
| Maximum axle weight                  | 3.0T                        | 4.0T       |
| Maximum wheel weight                 | 1.5T                        | 2.0T       |
| Maximum displacement                 | ±35mm                       | ±50mmx2    |
| Dimensions platform (LxW)            | 630x630mm                   | 620x545mm  |
| Two Plates Inner Width x Outer Width | 710x1970mm                  | 840x2280mm |
| Maximum plate rotation               | ±14°                        | /          |
| Motor                                | 2.2kW                       |            |
| Working Mode                         | Hydraulic Drive             |            |
| Electrical supply                    | According To Customer Needs |            |

\* Machine shown with optional equipment. Actual product appearance may differ.

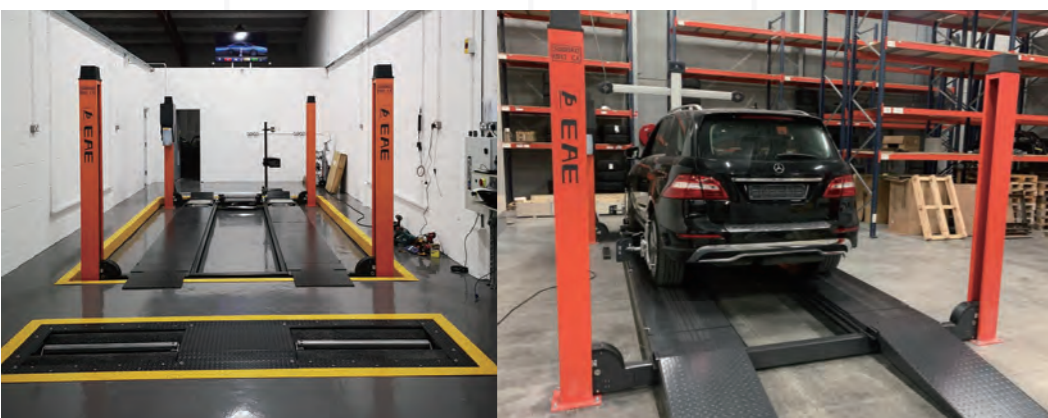

4.5T  
Lifting Capacity

2300mm  
Extended Platform

ALS  
Automatic leveling system



**OVERALL DIMENSION**

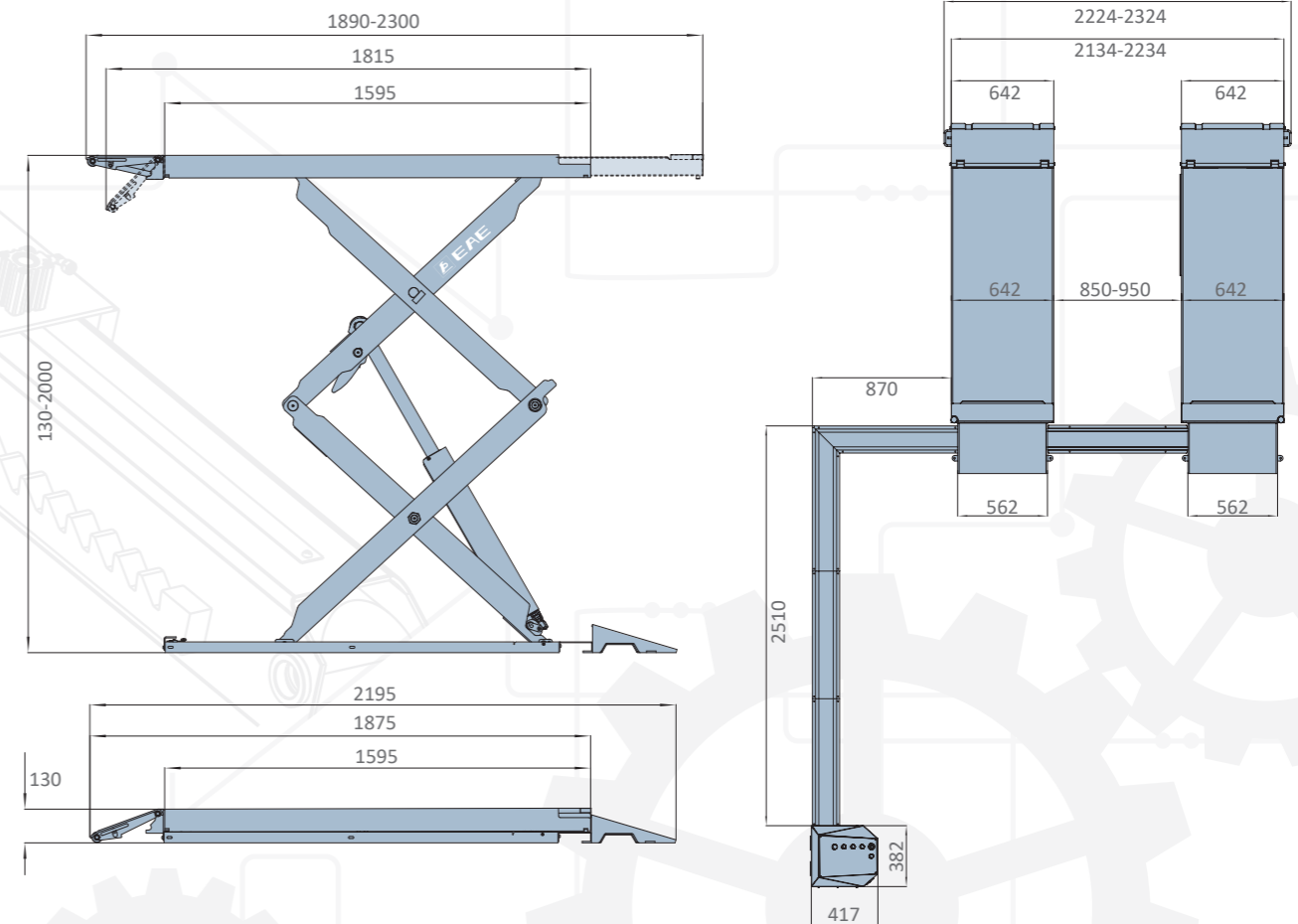

**LS45**

**FULL RISE SCISSOR LIFT**

- Rated Capacity 4500kg, suitable for most sedans, heavy-duty SUVs, pickup trucks and vans.
- 130mm low profile allows for surface-level installation.
- A maximum lifting height of 2000mm, providing greater under-vehicle workspace.
- Platform maximally extends to 2300 mm, fits both short-wheelbase compact cars and long-wheelbase passenger vans
- Four-Cylinder Drive for enhanced stability and synchronized lifting.
- Total hydraulic redundancy replaces mechanical latches, preventing uncontrolled movement and eliminating the need to raise before lowering.
- One-button Auto-Leveling. Simple and Efficient.
- Out-of-level photoelectric sensor guards against risks of non-synchronization due to blockage or leakage.
- Anti-burst hydraulic valve ensures descent at safe speed in the event of accidental leakage.
- Low-position stop and audible alarm for the final travel below the stop position.
- Aluminum Shell Motor: Rapid dissipation, consistent efficiency.
- 24V Safe Control System and a sealed ABS enclosure to prevent electric shock, moisture damage, and electrical leakage.
- Greaseable bearings at all pivot points for extended service life and sustained stability.

**TECHNICAL DATA**

| MODEL NO.           | LS45                        |
|---------------------|-----------------------------|
| Lifting capacity    | 4.5T                        |
| Max. lifting height | 2000mm                      |
| Min. height         | 130mm                       |
| Lifting time        | Approx. 55S                 |
| Motor               | 3.5kW/3ph                   |
| Air supply          | 6-8bar                      |
| Platform width      | 642mm                       |
| Electricity supply  | According To Customer Needs |

\* Machine shown with optional equipment. Actual product appearance may differ.

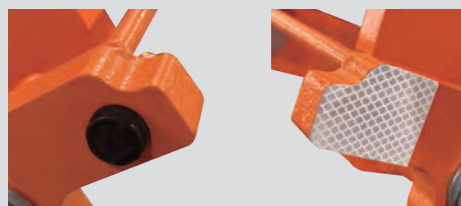

Photoelectric Sensor For Out-of-level Protection

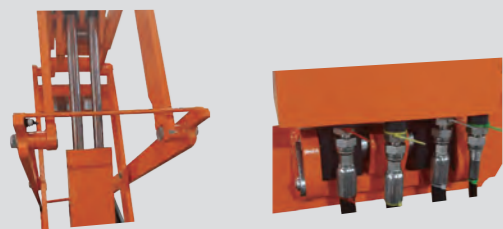

Four-Cylinder Drive



Hydraulic Lock

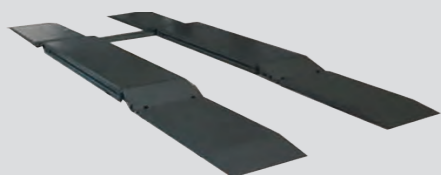

Platform Extension (optional)

3.5T Lifting Capacity | 105MM Drive-on Height | 1980MM Max. Lifting Height | 2300MM Max. Platform Length | **CE**



**OVERALL DIMENSION**

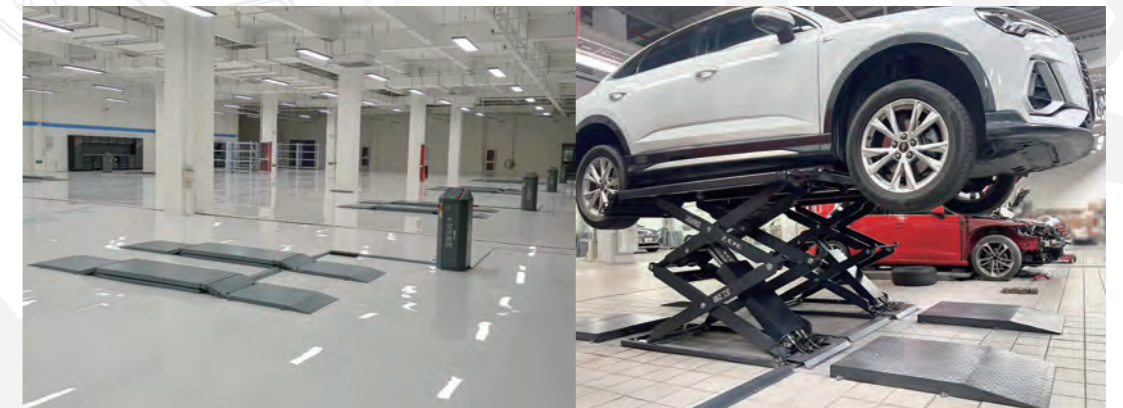
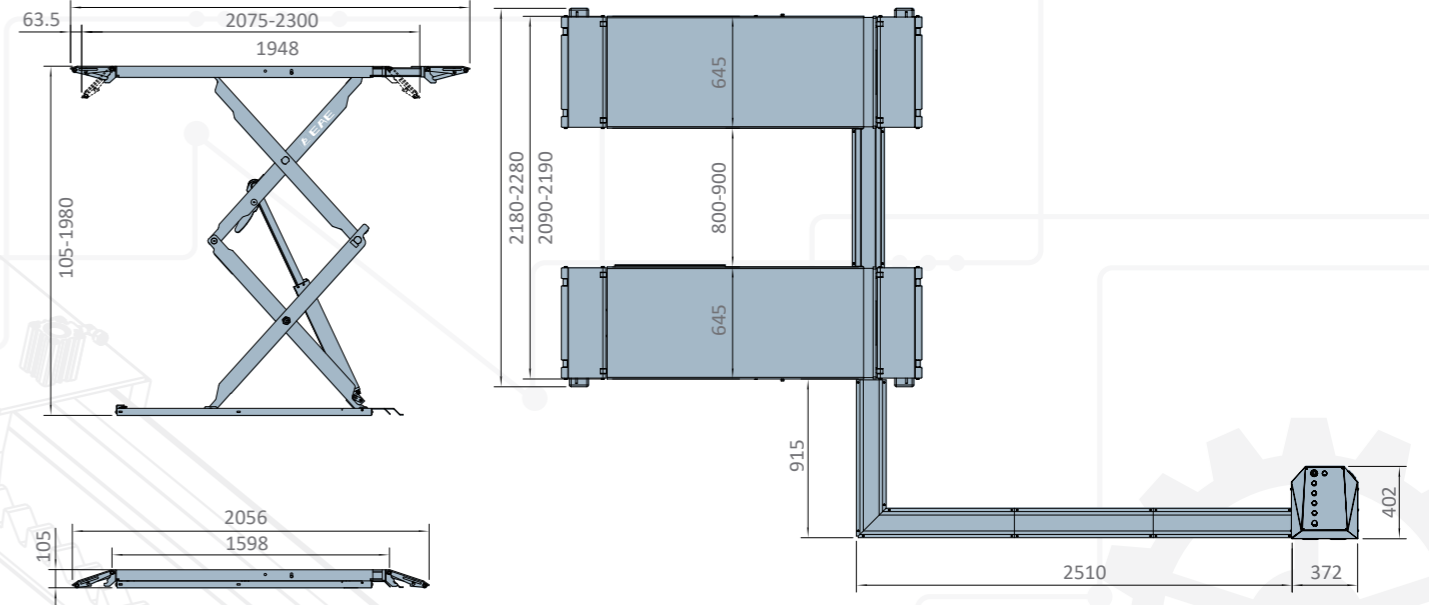

**6501**  
**FULL RISE SCISSOR LIFT**

- 3.5T lifting capacity.
- The profile is as low as 105mm, perfect for surface mounting.
- Platforms can be extended maximally to 2300mm.
- Picked-up wheelbase can be up to 3400mm.
- Out-of-level photoelectric sensor guards against risks of non-synchronization due to blockage or leakage.
- Users' safety is double guaranteed by using both mechanical latches and restrictive valves.
- Reliable automatic-synchronization system.
- More free space under lifted vehicles due to maximally narrowed platform width and maximally enhanced rising height.
- 24V safe control system.

**TECHNICAL DATA**

|                     |                             |
|---------------------|-----------------------------|
| MODEL NO.           | 6501                        |
| Lifting capacity    | 3.5T                        |
| Max. lifting height | 1980mm                      |
| Min. height         | 105mm                       |
| Lifting time        | Approx. 45S                 |
| Motor               | 3.5kW/3ph                   |
| Platform width      | 645mm                       |
| Weight              | 900kg                       |
| Electricity supply  | According To Customer Needs |



Photoelectric Sensor For Out-of-level Protection

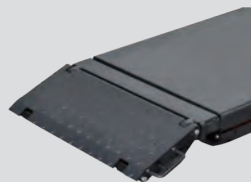

Drive-on Ramp



Electrical Released

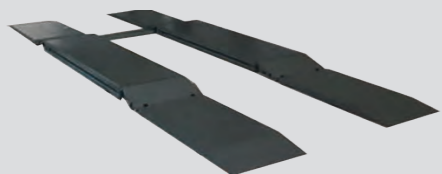

Platform Extension (optional)

**4.0T** Lifting Capacity | **Extendable Platform** Double Sides | **ALS** Automatic leveling system | **CE**



**OVERALL DIMENSION**

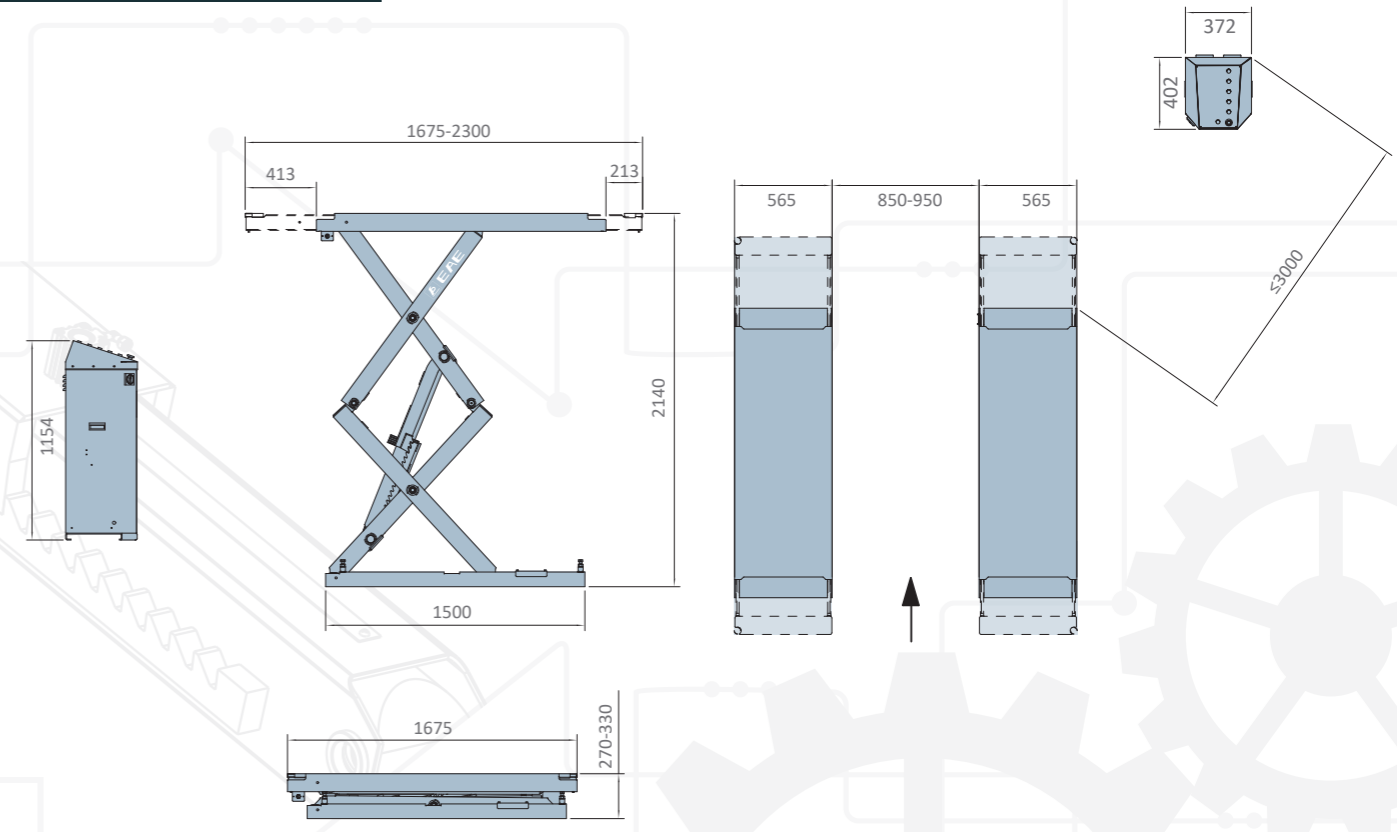

**TECHNICAL DATA**

|                     |                             |
|---------------------|-----------------------------|
| MODEL NO.           | HS40                        |
| Lifting capacity    | 4.0T                        |
| Max. lifting height | 2140mm                      |
| Min. height         | 270mm                       |
| Lifting time        | Approx. 45S                 |
| Motor               | 3.5kW/3ph                   |
| Air supply          | 6-8bar                      |
| Platform width      | 565mm                       |
| Electricity supply  | According To Customer Needs |

\* Machine shown with optional equipment. Actual product appearance may differ.



**HS40**

**FULL RISE SCISSOR LIFT**

- Rated Capacity 4000kg, suitable for most sedans, heavy-duty SUVs, pickup trucks and vans.
- Platform Length, extendable from 1675 mm to 2300 mm, fits both short-wheelbase compact cars and long-wheelbase passenger vans
- Minimum height adjustable (270-330mm) to match existing pit floors
- Four-Cylinder Drive for enhanced stability and synchronized lifting.
- One-button Auto-Leveling. Simple and Efficient.
- Mechanical latch prevents uncontrolled descent at raised positions. Pneumatic release for stable performance at low maintenance cost.
- Out-of-level photoelectric sensor guards against risks of non-synchronization due to blockage or leakage.
- Anti-burst hydraulic valve ensures descent at safe speed in the event of accidental leakage.
- Low-position stop and audible alarm for the final travel below the stop position.
- Aluminum Shell Motor: Rapid dissipation, consistent efficiency.
- 24V Safe Control System and a sealed ABS enclosure to prevent electric shock, moisture damage, and electrical leakage.
- Greaseable bearings at all pivot points for extended service life and sustained stability.



Photoelectric Sensor For Out-of-level Protection



Pneumatic Release Mechanical Lock



Anti-burst Hydraulic Valve

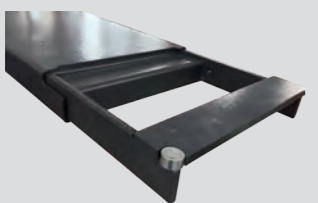

Platform Extension

**3.5T** Lifting Capacity | **Extendable Platform** One Side or Double Sides | **ALS (OPTIONAL)** Automatic leveling system | **CE**



**OVERALL DIMENSION**

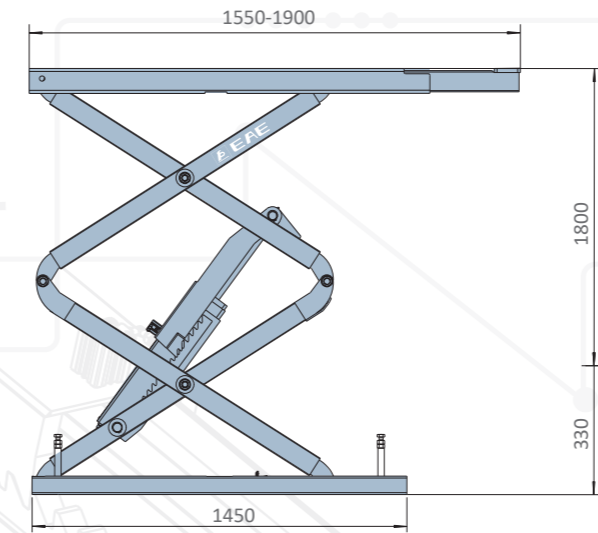

Single side platform extension

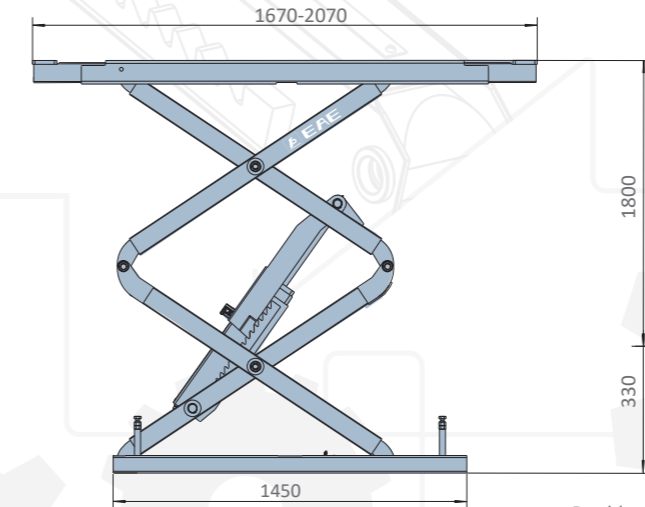

Double sides platform extension

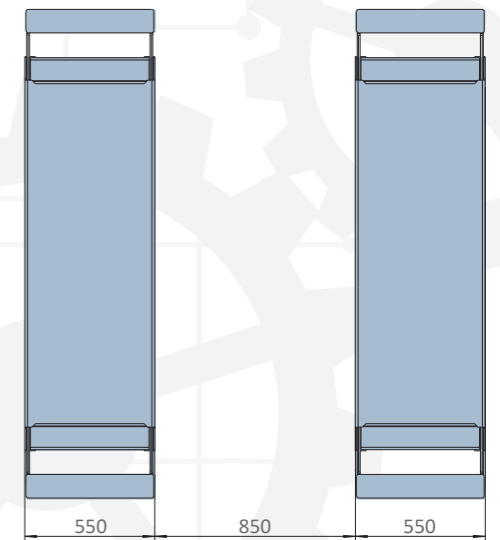
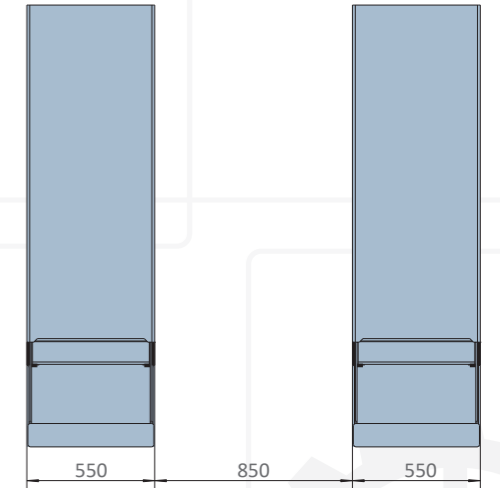

SCISSOR LIFT

**TECHNICAL DATA**

|                     |                             |
|---------------------|-----------------------------|
| <b>MODEL NO.</b>    | 6503                        |
| Lifting capacity    | 3.5T                        |
| Max. lifting height | 2130mm                      |
| Min. height         | 330mm                       |
| Lifting time        | Approx. 40S                 |
| Motor               | 3.5kW/3ph                   |
| Air supply          | 6-8bar                      |
| Platform width      | 550mm                       |
| Weight              | 741kg                       |
| Electricity supply  | According To Customer Needs |



**6503**

**FULL RISE SCISSOR LIFT**

- 3.5T lifting capacity.
- Recessed installation.
- Infrared synchronization protection system.
- Pneumatic released safety locking system.
- Platforms can be extended for long vehicles.
- Durable cylinders with anti-surge valves.
- 24V safe control system.
- Height limit switch.
- Safety descent alarming buzzer.
- Powder coated finish.
- Self-lubricated bushing and bearing.
- Aluminum motor, no risks of overheating.



Cylinder Support



High Quality Ball Valve



Pneumatic Release Mechanical Lock



24v Safe Control System

\* Machine shown with optional equipment. Actual product appearance may differ.

**3.5T** Lifting Capacity | **110MM** Drive-on Height | **Starting-Up Plate** for Easy Raising at Low Point | **CE**



**OVERALL DIMENSION**

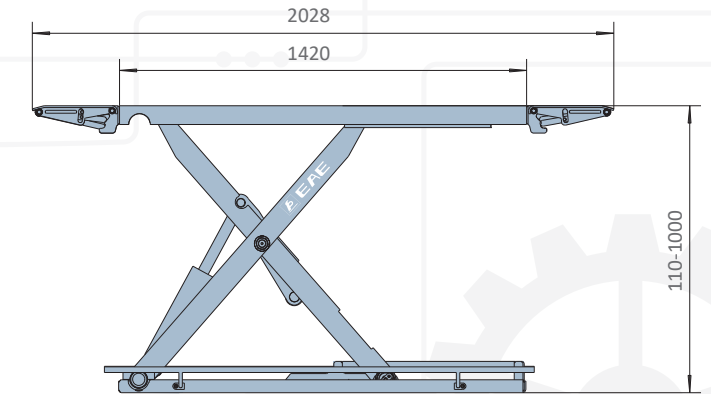
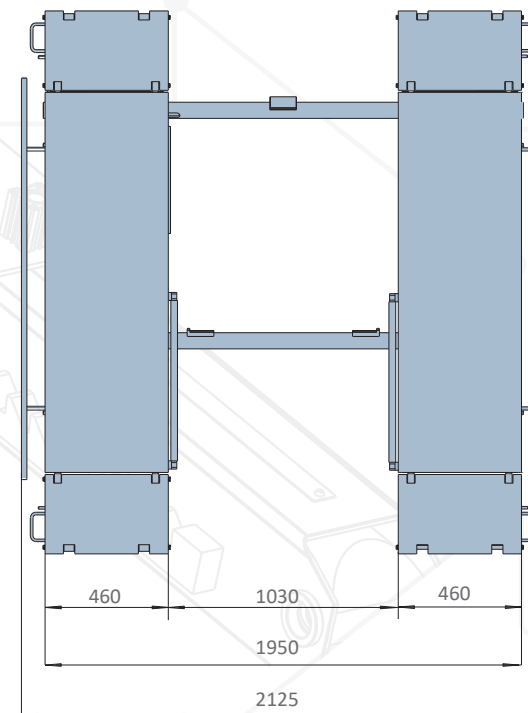

**TECHNICAL DATA**

| MODEL NO.           | MR35                        |
|---------------------|-----------------------------|
| Lifting capacity    | 3.5T                        |
| Max. lifting height | 1000mm                      |
| Min. height         | 110mm                       |
| Lifting time        | Approx. 30S                 |
| Motor               | 2.2kW                       |
| Platform width      | 460mm                       |
| Weight              | 580kg                       |
| Electricity supply  | According To Customer Needs |

\* Machine shown with optional equipment. Actual product appearance may differ.



**MR35**

**MID RISE SCISSOR LIFT**

- 3.5T lifting capacity.
- Ideal for tire service and narrow bays.
- Mobile design.
- Electrical released safety locking system.
- Durable cylinders with anti-surge valves.
- 24V safe control system.
- Height limit switch.
- Powder coated finish.
- Self-lubricated bushing and bearing.
- The safeguard against one-end tilting.
- Drive-up ramps lock into position as platform extension for long vehicles.
- Optional mobile kit makes it easy to move the lift around you garage.
- Aluminum motor, no risks of overheating.

Low Voltage & Movable Control Unit

Start-Up plate

The safeguard against one end tilting.

Drive-on ramps lock into position as platform extension for long vehicles.

Mechanical Safety Lock

Optional mobile kit makes it easy to move the lift around you garage.

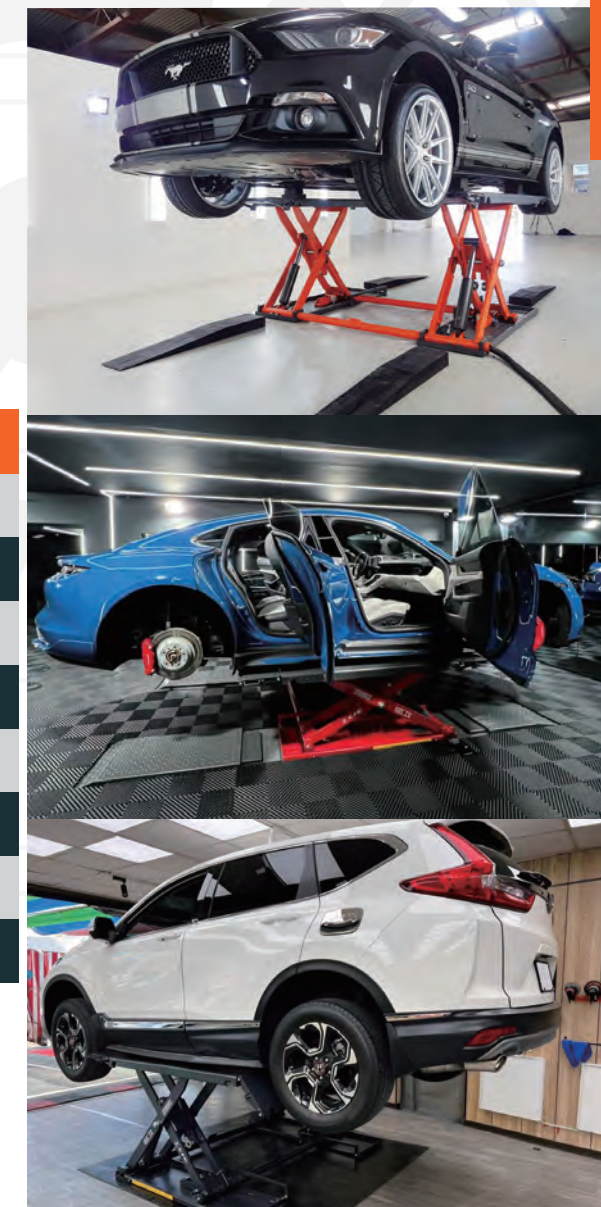

SCISSOR LIFT

3.0T Lifting Capacity | 105MM Drive-on Height | Double Safety Hydraulic and Mechanical | **CE**



**OVERALL DIMENSION**

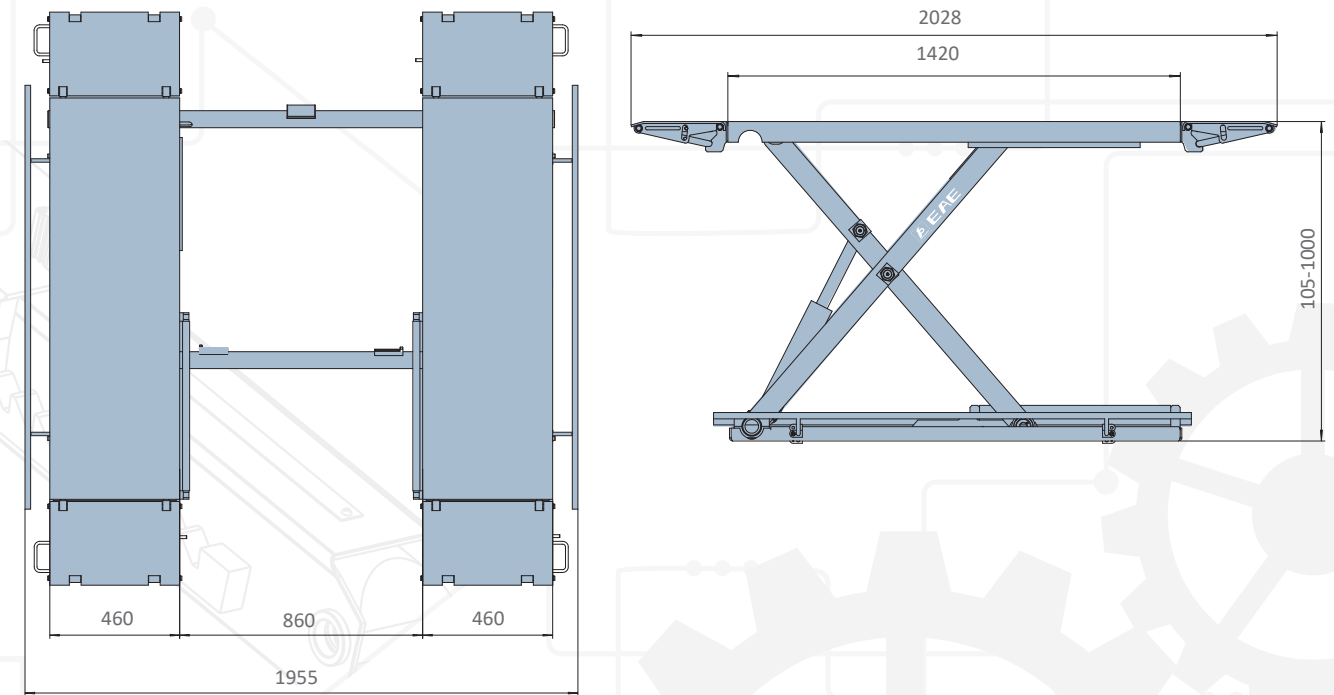

**MR30**

**MID RISE SCISSOR LIFT**

- Ideal for tire service and narrow bays.
- Mobile design.
- 3.0T lifting capacity.
- Electrical released safety locking system.
- Durable cylinders with anti-surge valves.
- 24V safe control system.
- Height limit switch.
- Powder coated finish.
- Self-lubricated bushing and bearing.
- Drive-up ramps lock into position as platform extension for longer vehicles.
- Optional mobile kit makes it easy to move the lift around you garage.
- Aluminum motor, no risks of overheating.

**TECHNICAL DATA**

|                     |                             |
|---------------------|-----------------------------|
| MODEL NO.           | MR30                        |
| Lifting capacity    | 3.0T                        |
| Max. lifting height | 1000mm                      |
| Min. height         | 105mm                       |
| Lifting time        | Approx. 30S                 |
| Motor               | 2.2kW                       |
| Platform width      | 460mm                       |
| Weight              | 474kg                       |
| Electricity supply  | According To Customer Needs |

\* Machine shown with optional equipment. Actual product appearance may differ.



**1.2T**  
Lifting Capacity

**Dual-speed system**  
High Efficiency

**Movable**  
Space Saving



MS12M  
Hydraulic Driven



MS12MF  
Hydraulic Driven  
Electric mobile kit

New Energy Vehicle



Battery Pack



Electric Engine



Engine



Gearbox



Drive Axle



Fuel Tank

Fuel Vehicle

**OVERALL DIMENSION**

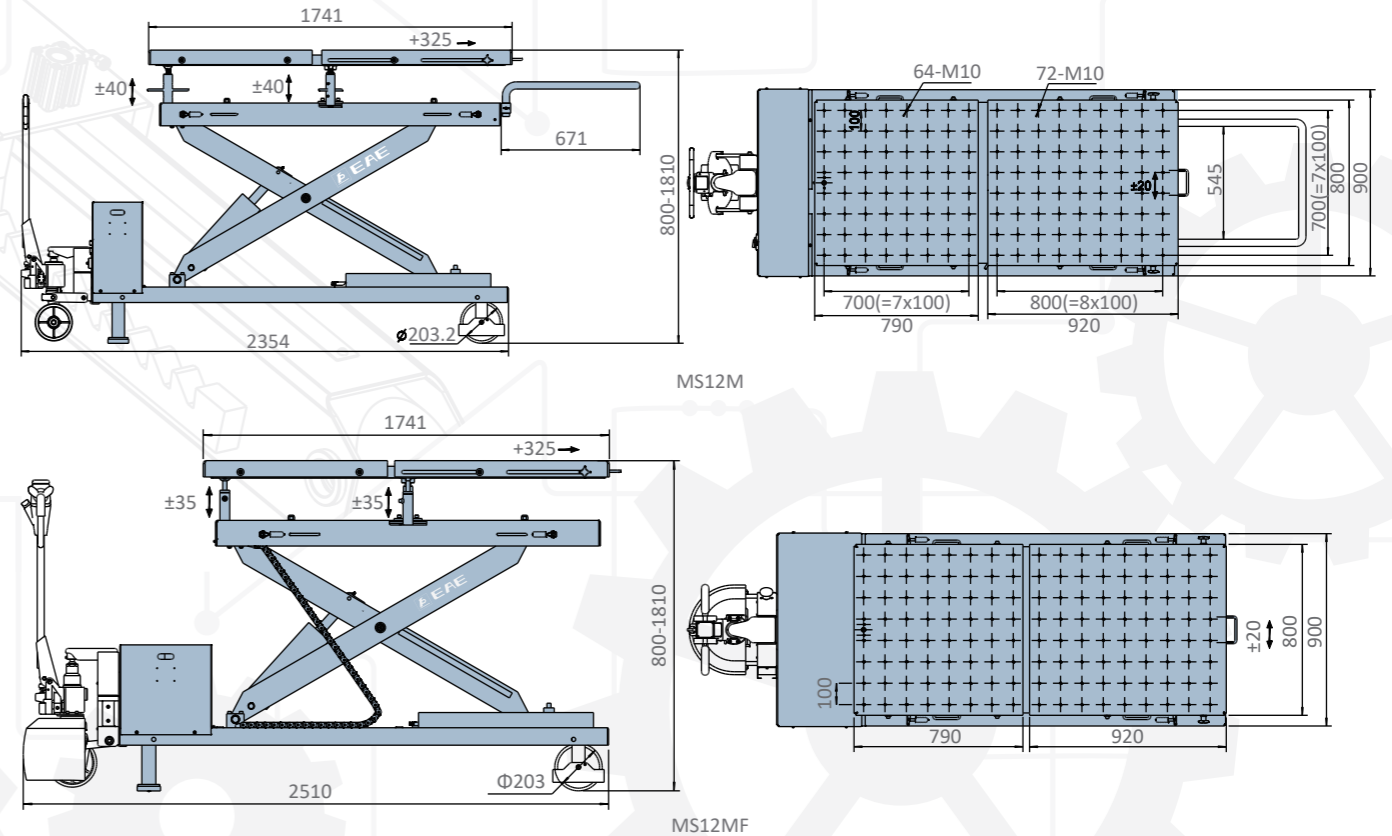

SCISSOR LIFT

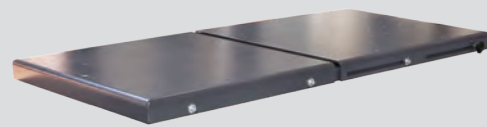

Reserved holes (100mm x100mm)



A max extension of 325mm in length



Electric mobile kit  
(MS12MF)



A dual-speed system for fast and precise lifting

**MS12M/MS12MF**

**HYDRAULIC MOBILE LIFTING TABLE**

- It is helpful to assemble and disassemble battery packs for electric vehicles and engine, gearbox, drive axle, fuel tank, suspension, bracket and chassis components for traditional vehicles.
- The suspend platform can tilt within a height of 40mm. The lower platform can move laterally within a distance of 20mm. This could meet multiple practical needs.
- Reserved holes (100mm x100mm) on the working table for positioning and fixing components with specialized fixtures.
- The lifting table also features a dual-speed system for fast and precise lifting.
- Maintain an ease and stable running and prolong the service time of shaft bearings.
- Oil hose with double steel wire fabrications, which has passed pressure test under 40MPa and can work under twice the nominal working pressure without breakage.
- Electric mobile kit let it be freely moved without much effort. (MS12MF)
- Electrically released mechanical locking system.
- 24V Control System Three-pin plug.
- Hand-held button control with stop function.

**TECHNICAL DATA**

| MODEL NO.                | MS12M          | MS12MF       |
|--------------------------|----------------|--------------|
| Max. capacity            | 1.2T           | 1.2T         |
| Max. height              | 1810mm         | 1810mm       |
| Min. Height              | 800mm          | 800mm        |
| Platform length          | 1741mm+325mm   | 1741mm+325mm |
| Platform width           | 800mm          | 800mm        |
| Voltage                  | 110V/220V/230V | DC12Vx2      |
| Motor                    | 1.5kW          | 2.0kW        |
| Full stroke time(Normal) | Approx.45S     | Approx.35S   |
| Full stroke time(Slow)   | Approx.100S    | 80S-90S      |

\* Machine shown with optional equipment. Actual product appearance may differ.



1.0T  
Lifting Capacity

Pneumatic Driven  
Hydraulic Pump

Movable  
Space Saving



OVERALL DIMENSION

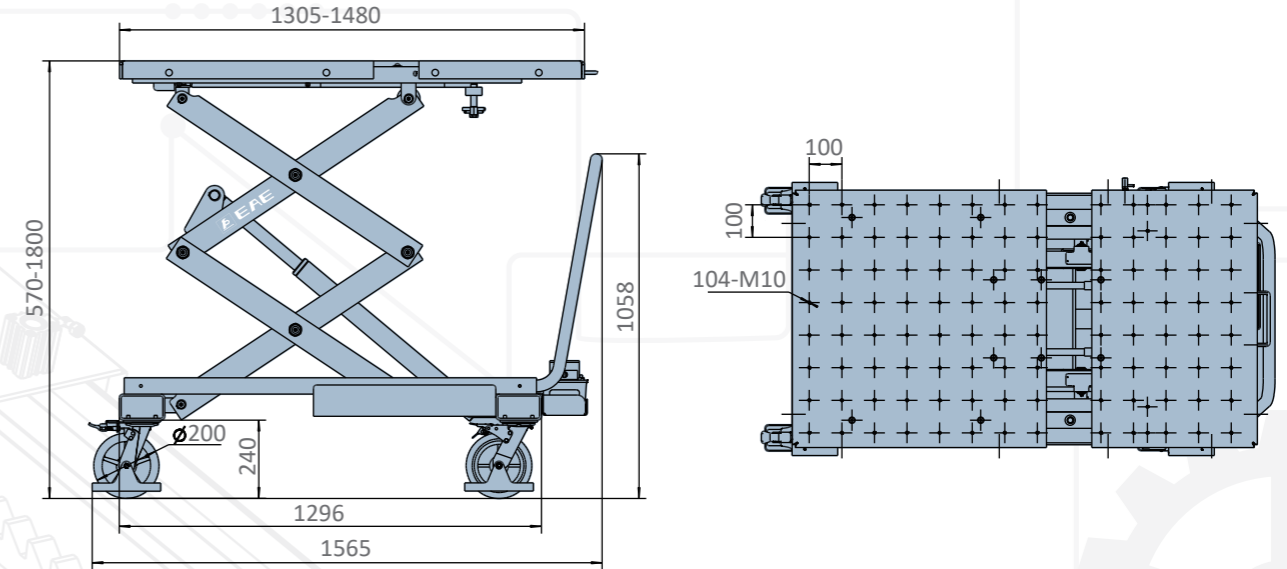

TECHNICAL DATA

|                                 |               |
|---------------------------------|---------------|
| MODEL NO.                       | MS10          |
| Rated Capacity                  | 1.0T          |
| Full rise height                | 1800mm        |
| Initial height                  | 570mm         |
| Air supply pressure             | 6-8bar        |
| Full rise time(with rated load) | 110S          |
| Platform Width                  | 800mm         |
| Platform Length                 | 1305mm-1480mm |

\* Machine shown with optional equipment. Actual product appearance may differ.

**MS10**

MOBILE LIFTING TABLE

- Designed for dismantling and fixing battery packs of electric vehicles as well as engine, gearbox, drive axle, fuel tank, suspension, bracket and chassis components of traditional vehicles.
- Control and power by foot activated pneumatic driven hydraulic pump.
- The working table can be tilted by adjusting two independent screws attached with T shape handle.
- The working table can be extended to 1480mm in length for more applications.
- Reserved holes (100mmx100mm) on the working table for positioning and fixing components with specialized fixtures.
- Four heavy-duty and abrasion-resisting casters can steer and move easily and brake effectively.
- Optional non-slip rubber pad to increase friction and avoid clashing with the battery packs.
- Hydraulic cylinder and seal rings with high quality. Overload dynamic test under 115% of the rated capacity.
- Larger base frame ensures better stability and reliability.
- Reserved holes at both sides of the working table for fixing loads with proper straps.
- Powder-coating surface ensure long time use without peeling off.

The working table can be extended to 1480mm in length for more applications.

Control and power by foot activated pneumatic driven hydraulic pump.

Four heavy-duty and abrasion-resisting casters can steer and move easily and brake effectively.



6.0T Lifting Capacity | 5424MM Long Platform | All Versions S, B, BWF Platforms | **CE**



Optional ramps for on-ground installation

**OVERALL DIMENSION**

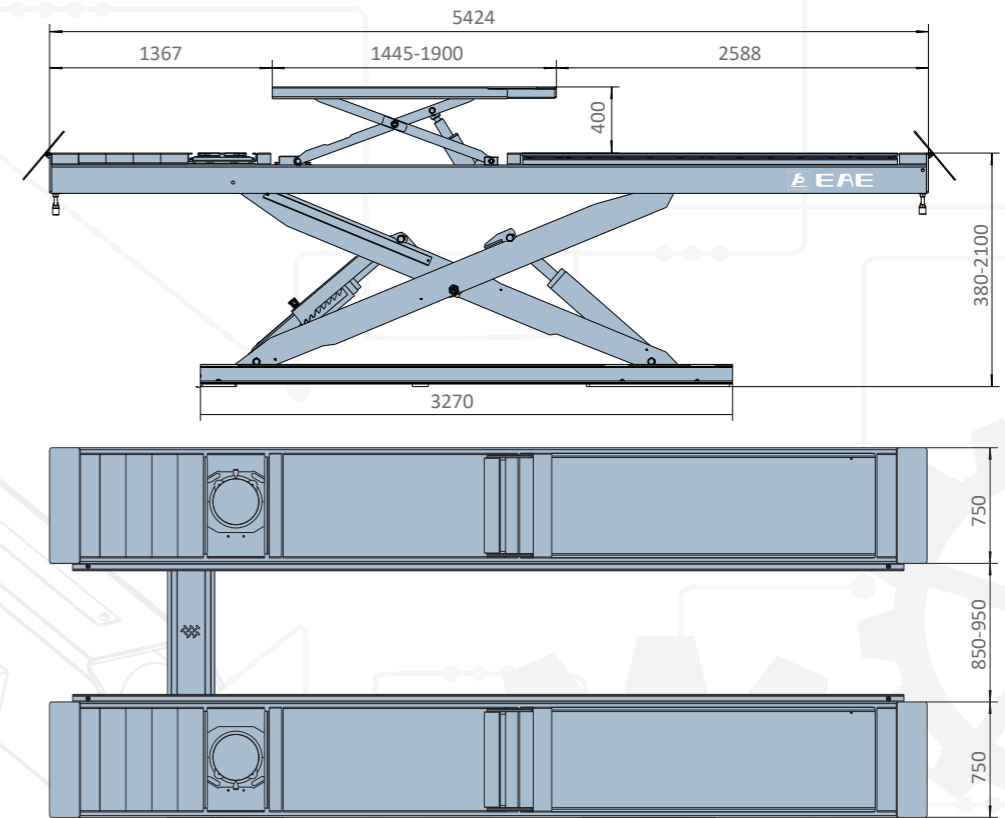

- S Flat platforms
- B Platforms with front recesses and rear slip plates
- BWF Platforms with front recesses, rear slip plates, and wheel free lifts

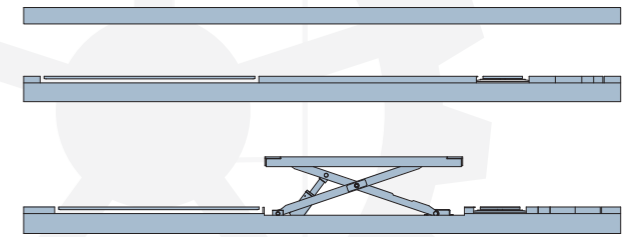

**HX6**  
**LONG PLATFORM SCISSOR LIFT**

- 6.0T lifting capacity.
- Infrared synchronization protection system.
- The great planeness of runways is perfect for high accuracy wheel aligning.
- Long slip plate and adjustable turntable positions accommodate different size of wheelbases.
- Easy one-touch pneumatic locking and release of slip plates, eliminating manual handling for technicians.
- Pneumatic released safety locking system.
- 24V safe control system.
- Self-lubricated bushing and bearing.
- Safety descent alarming buzzer.
- Aluminum motor, no risks of overheating.
- Standard Magnetic LED lamp for optimal lighting.
- Standard runway rails accept optional jacking beams.
- It has been proofed by dynamic test with 115% of rated capacity and static test with 150% capacity.

**TECHNICAL DATA**

| MODEL NO.           | HX6                         |
|---------------------|-----------------------------|
| Lifting capacity    | 6.0T                        |
| Max. lifting height | 2100mm                      |
| Min. height         | 380mm                       |
| Lifting time        | Approx. 45S                 |
| Motor               | 3.5kWx2/3ph                 |
| Air supply          | 6-8bar                      |
| Platform width      | 750mm                       |
| Weight              | 5255kg                      |
| Electricity supply  | According To Customer Needs |

\* Machine shown with optional equipment. Actual product appearance may differ.



**5.5T** Lifting Capacity | **245MM** Drive-on Height | **Surface Installation** No More Concrete Work, Ramps Included



**OVERALL DIMENSION**

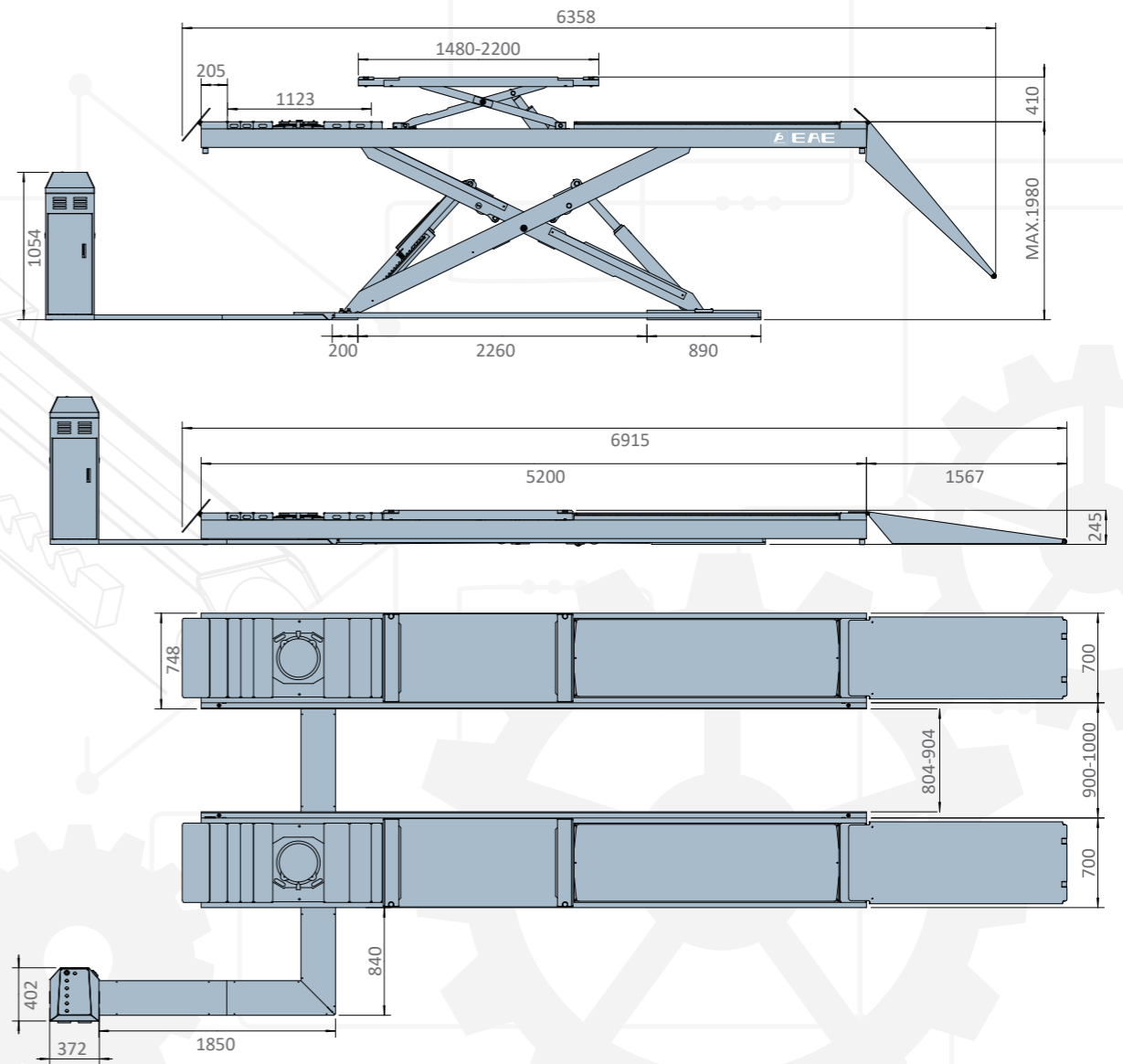

**LX55**  
**LOW PROFILE SCISSOR LIFT**

- 245mm low profile allows for surface-level installation.
- Opposed front/rear oil cylinder support structure guarantees level parking for precise wheel alignment.
- Available in two main platform lengths (4800mm / 5200mm) to suit different workshop spaces and vehicle types.
- Four-cylinder driven with one-button automatic leveling for simple, efficient operation.
- Easy one-touch pneumatic locking and release of slip plates, eliminating manual handling for technicians.
- Wheel-free lift, rated load for 4000kg and extendable platform length (1480-2200mm) for compact cars or long-wheelbase vehicles.
- Four portable LED lamps attached magnetically by the platform to provide sufficient light under vehicles.
- Standard runway rails accept optional jacking beams.
- Out-of-level photoelectric sensor guards against risks of non-synchronization due to blockage or leakage.
- Anti-burst hydraulic valve ensures descent at safe speed in the event of accidental leakage.
- Low-position stop and audible alarm for the final travel below the stop position.
- 24V Safe Control System and a sealed ABS enclosure to prevent electric shock, moisture damage, and electrical leakage.
- Quick-connect air couplings for rapid connection to pneumatic tools and tire inflators.

**TECHNICAL DATA**

| MODEL NO.           | LX55                        |
|---------------------|-----------------------------|
| Lifting capacity    | 5.5T                        |
| Max. lifting height | 1980mm                      |
| Min. height         | 245mm                       |
| Lifting time        | Approx. 60S                 |
| Motor               | 3.5kW/3ph                   |
| Air supply          | 6-8bar                      |
| Platform width      | 700mm                       |
| Electricity supply  | According To Customer Needs |

\* Machine shown with optional equipment. Actual product appearance may differ.

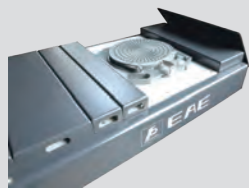

Turntable (Optional)

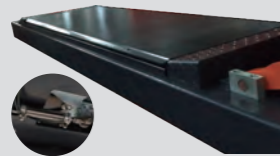

Pneumatic Rear Side Slip



Anti-abrasion Slider



Drive-on Ramp



Pneumatic Release Mechanical Lock

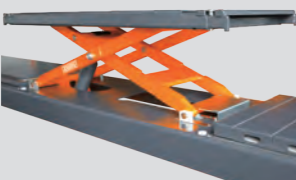

Wheel Free Lift (BWF) (4000KG)

**5.0T**  
Lifting Capacity

**2130MM**  
Full Travel

**25S**  
Full-Rise Time

**8 DIRECTIONS**  
Play Detector



**OVERALL DIMENSION**

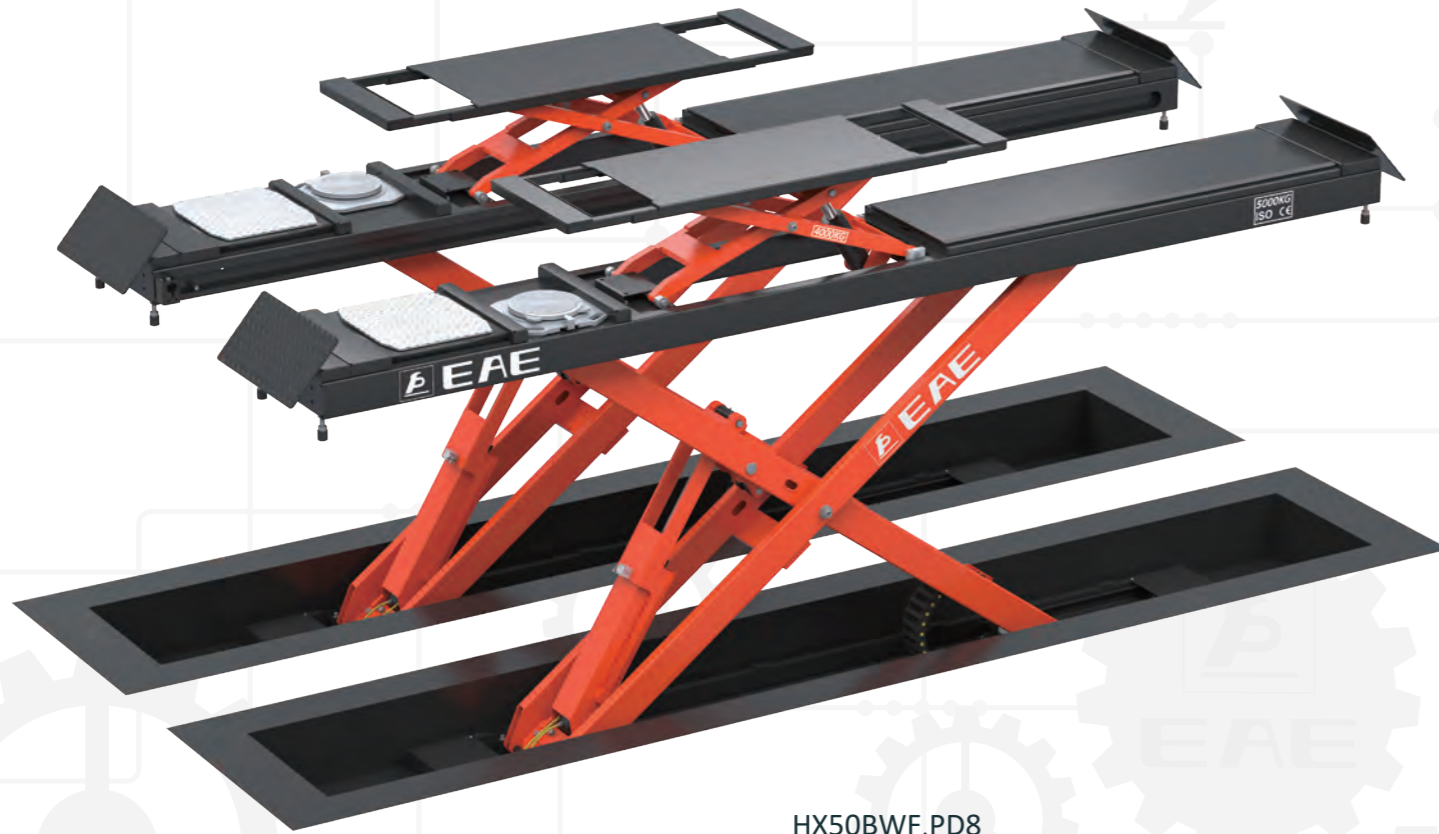

HX50BWF.PD8

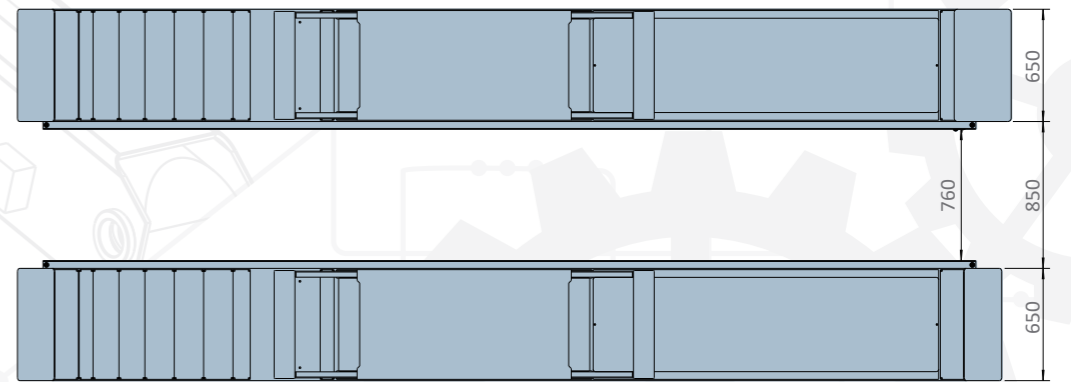
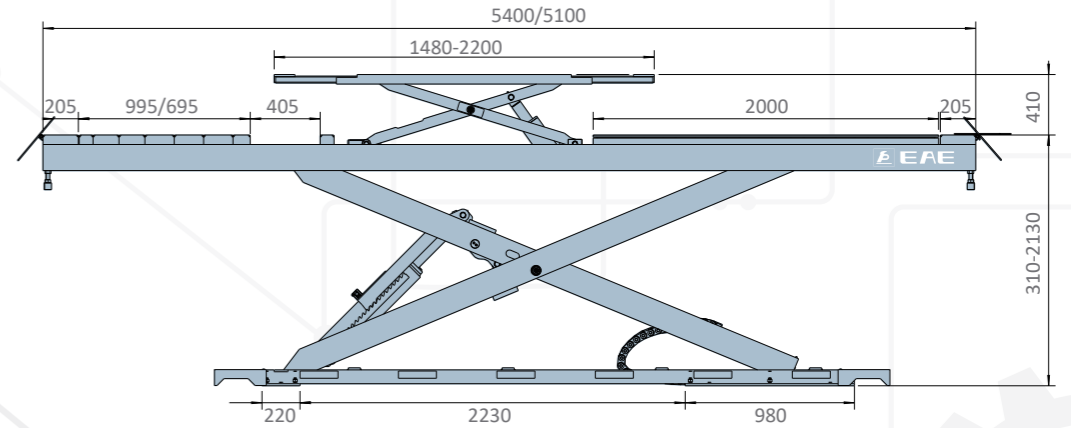

B Platforms with front recesses and rear slip plates

BWF Platforms with front recesses, rear slip plates, and wheel free lifts

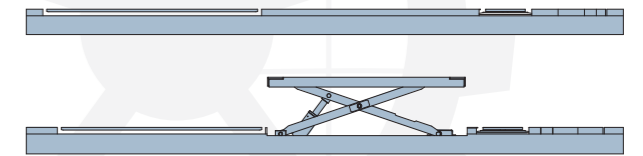

**HX50**

**ALIGNMENT SCISSOR LIFT**

- Maximum lifting height 1820mm above floor.
- Available in two main platform lengths (5400mm / 5100mm) to suit different workshop spaces and vehicle types.
- Infrared synchronization protection system.
- The most of vehicles can be lifted by the Wheel-free Lifting Platform, which loads up to 4.0T and extends up to 2200mm.
- Only 25 seconds for raising to shorten your service time.
- Flexible positions for turning plates. Accurate wheel-alignment is efficiently done using its pneumatic-controlled slip plates together with the radius turning plates.
- Easy one-touch pneumatic locking and release of slip plates, eliminating manual handling for technicians.
- Four portable LED lamps attached magnetically by the platform to provide sufficient light under vehicles.
- Standard runway rails accept optional jacking beams.
- Optional Play Detector, with its longitudinal and transversal movement being as much as 100 mm, is made as per the DIRECTIVE 2014/45/EU.

**TECHNICAL DATA**

| MODEL NO.           | HX50                        |
|---------------------|-----------------------------|
| Lifting capacity    | 5.0T                        |
| Max. lifting height | 2130mm(1820mm above floor)  |
| Min. height         | 310mm                       |
| Lifting time        | Approx. 25S                 |
| Motor               | 3.5kWx2/3ph                 |
| Air supply          | 6-8bar                      |
| Platform width      | 650mm                       |
| Electricity supply  | According To Customer Needs |

\* Machine shown with optional equipment. Actual product appearance may differ.

Low Voltage Control Unit

Pneumatic Rear Side Slip

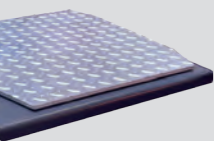

PD8 (Optional)

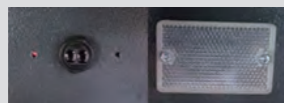

Infrared synchronization protection system



Pneumatic Release Mechanical Lock



Wheel Free Lift (4000KG)

5.0T Max. Capacity | 5300MM Max. Platform Length | ALS Automatic leveling system | CE



**OVERALL DIMENSION**

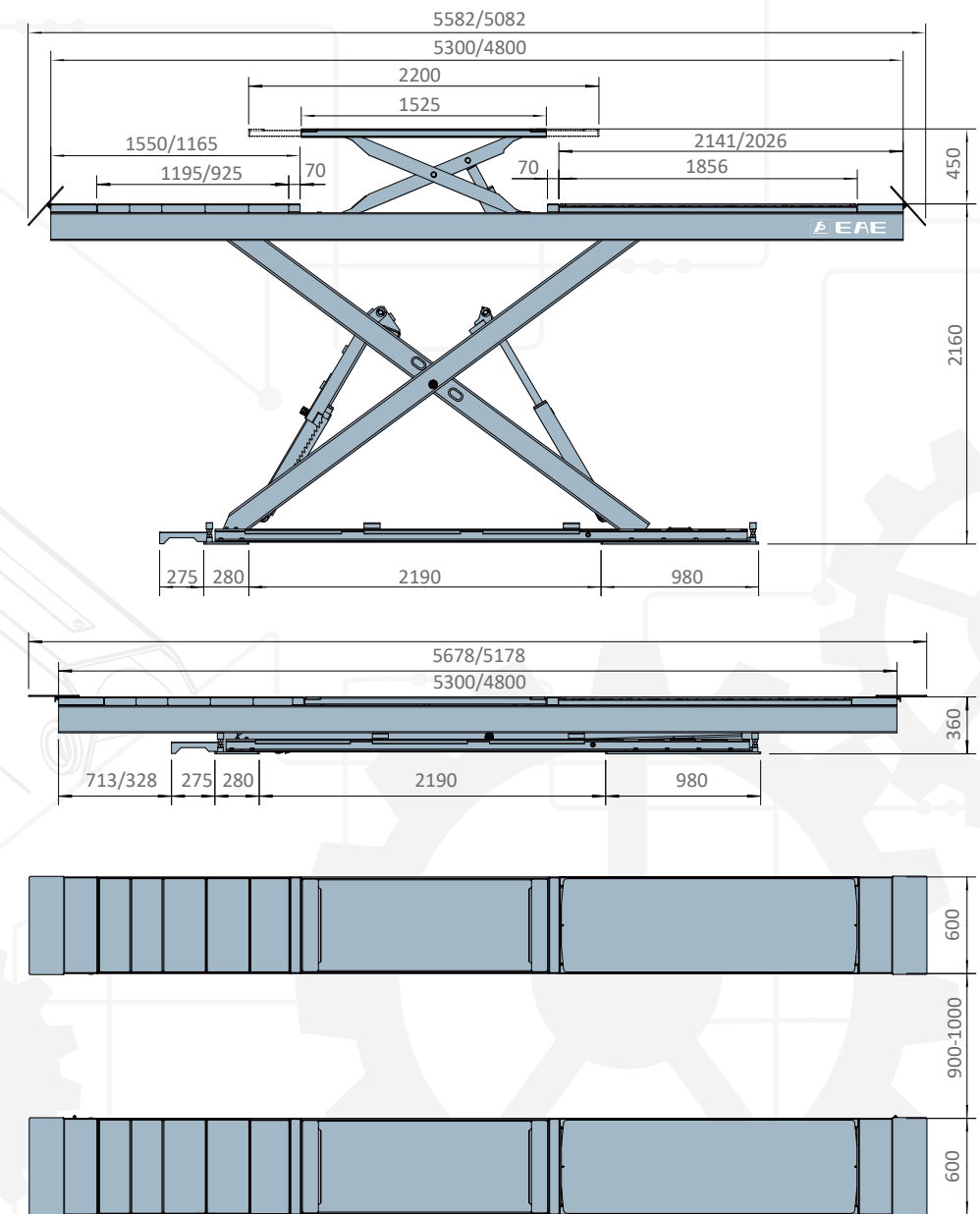

**DX50**  
**ALIGNMENT SCISSOR LIFT**

- Flush-mounted, enabling the easiest drive-on access, even for low-clearance vehicles.
- A maximum lifting height of 2160mm (1800mm above ground level for flush-mounted) provides greater under-vehicle clearance.
- Available in two main platform lengths (4800mm / 5300mm) to suit different workshop spaces and vehicle types.
- Opposed front/rear oil cylinder support structure guarantees level parking for precise wheel alignment.
- Four-cylinder driven with one-button automatic leveling for simple, efficient operation.
- Easy one-touch pneumatic locking and release of slip plates, eliminating manual handling for technicians.
- Wheel-free lift, rated load for 3500kg and extendable platform length (1525-2200mm) for compact cars or long-wheelbase vehicles.
- Standard Magnetic LED lamp for optimal lighting.
- Mechanical latch prevents uncontrolled descent at raised positions. Pneumatic release for stable performance at low maintenance cost.
- Out-of-level photoelectric sensor guards against risks of non-synchronization due to blockage or leakage.
- Anti-burst hydraulic valve ensures descent at safe speed in the event of accidental leakage.
- 24V Safe Control System and a sealed ABS enclosure to prevent electric shock, moisture damage, and electrical leakage.
- Quick-connect air couplings for rapid connection to pneumatic tools and tire inflators.
- Optional runway rails.

**TECHNICAL DATA**

| MODEL NO.           | DX50                        |
|---------------------|-----------------------------|
| Lifting capacity    | 5000kg                      |
| Max. lifting height | 2160mm                      |
| Min. height         | 360mm                       |
| Lifting time        | Approx. 55S                 |
| Motor               | 3.5kW/3ph                   |
| Air supply          | 6-8bar                      |
| Platform width      | 600mm                       |
| Electricity supply  | According To Customer Needs |

\* Machine shown with optional equipment. Actual product appearance may differ.



Wheel Free Lift (3500kg)

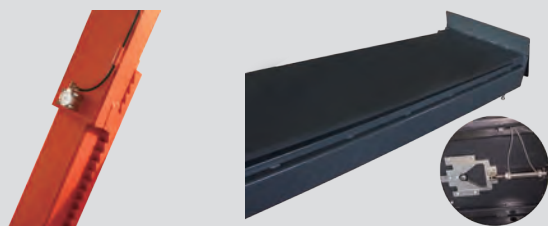

Mechanical Lock Pneumatic Release System

Pneumatic Rear Side Slip



Photoelectric Sensor For Out-of-level Protection

**3.5T**  
Lifting Capacity

**140MM**  
Drive-on Height

**Add-On**  
Wheel Alignment runway kit (B type)



**OVERALL DIMENSION**

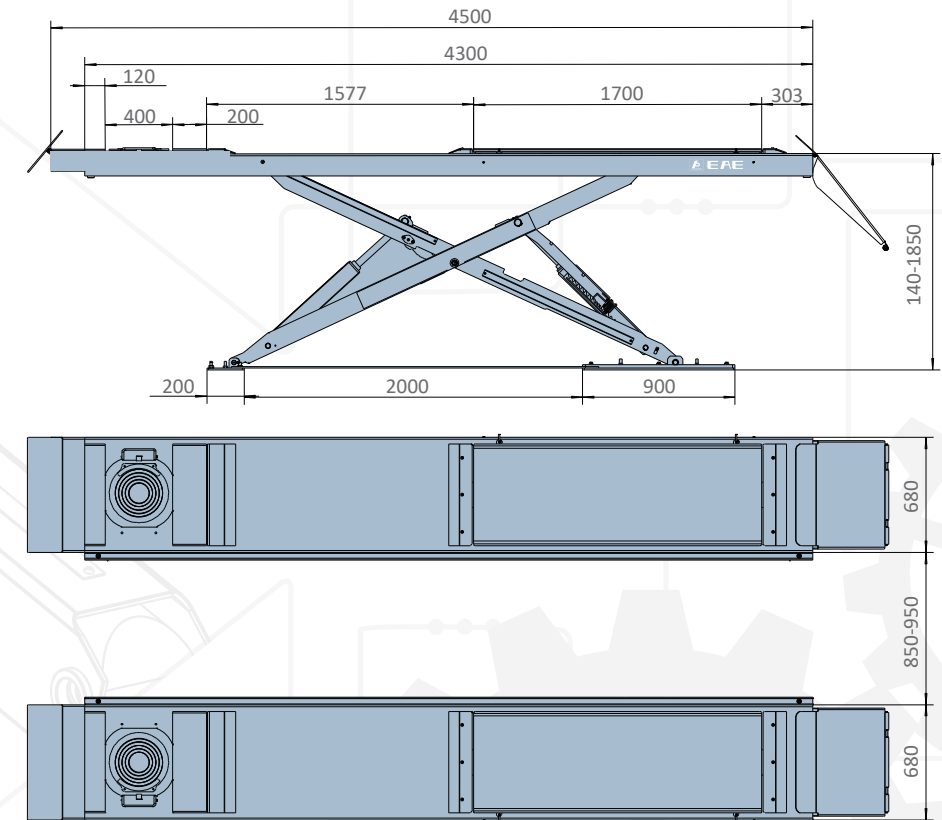

S Flat platforms

B Added on alignment kit

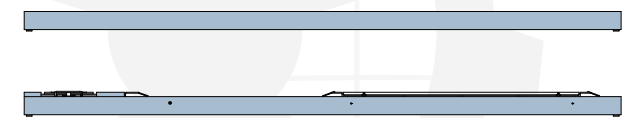

**LX35**

**LOW PROFILE SCISSOR LIFT**

- Six-Cylinder mechanical structure. Reliable mechanical locking system protects against rapture of hydraulic circuit and ensure better mechanical balance when it is engaged.
- Avoid rapid descending caused by leakages of hydraulic system by applying FLOW-CONTROL technique.
- Max height switch limits the travel of runways and ensures cylinders work within the stroke.
- Protect against pinching and shearing using alarming buzzer in descending process.
- 24V safety control voltage.
- Low profile runway design is less demanding on space and suitable for surface installation in basement and other place where it is forbidden to dig a pit.
- Flat and smooth runway (type S) is better for quick body checking service.
- Aluminum motor, no risks of overheating.
- Reserved tracks for optional jacks.
- Modular design meets various practical needs. It is possible to extend S runway to B runway with extra accessories.

**TECHNICAL DATA**

|                     |                             |
|---------------------|-----------------------------|
| <b>MODEL NO.</b>    | LX35                        |
| Lifting capacity    | 3.5T                        |
| Max. lifting height | 1850mm                      |
| Min. height         | 140mm                       |
| Lifting time        | Approx. 55S                 |
| Motor               | 3.5kW/3ph                   |
| Air supply          | 6-8bar                      |
| Platform width      | 680mm                       |
| Weight              | 2200kg                      |
| Electricity supply  | According To Customer Needs |

\* Machine shown with optional equipment. Actual product appearance may differ.



Reserved tracks for optional jacks

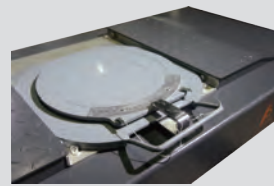

Turntable (Optional)

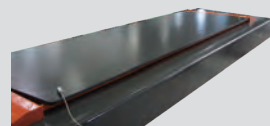

Add-on alignment kit



Mechanical Safety Lock



Low profile runway, 140mm initial drive-on height

**15T**  
Lifting Capacity

**8000MM**  
Long Runways of Each Platform

**Digital Data** **CE**



**OVERALL DIMENSION**

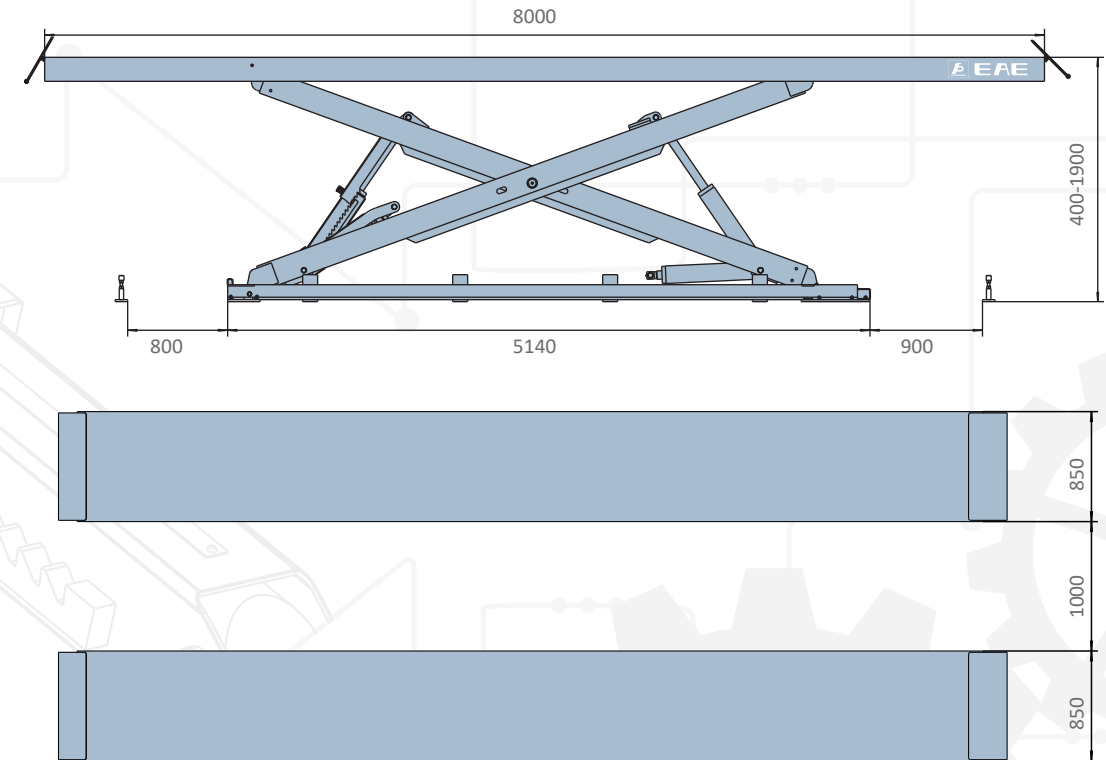

**TECHNICAL DATA**

|                                     |                             |
|-------------------------------------|-----------------------------|
| MODEL NO.                           | HX150                       |
| Lifting capacity                    | 15T                         |
| Max. lifting height                 | 1900mm                      |
| Min. height                         | 400mm                       |
| Complete rise time under rated load | Approx. 85S                 |
| Motor power                         | 3.5kWx2                     |
| Air supply                          | 6-8bar                      |
| Oil reservoir                       | 40L                         |
| Platform width                      | 850mm                       |
| Electricity supply                  | According To Customer Needs |

\* Machine shown with optional equipment. Actual product appearance may differ.



**HX150**  
**HEAVY DUTY SCISSOR LIFT**

- Hydraulic synchronization by four cylinders. The mechanical safety locking unit automatically releases before descending.
- Safe low control voltage (24V) for all control buttons and switches.
- Constantly read the height and working status of each platform through visual monitor.
- CLOSED-LOOP control system, the two platforms automatically align with each other during every rising and lowering cycles. In normal working, the height deviation is limited within 50mm.
- The lifting system stops working in case that the height deviation exceeds 50mm.



Constantly feed back the height and working status of each platform through visual monitor.

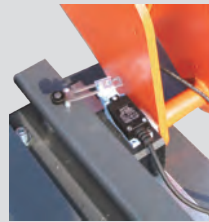

Limit switch to ensure the cylinders work within its maximal stroke.



sensor



4-cylinder synchronizing structure

**8.0T**  
Lifting Capacity

**Presetable Rising Height**  
Optimal Levelness



Easily extend to lift longer and heavier vehicles, such as Lorries.

**OVERALL DIMENSION**

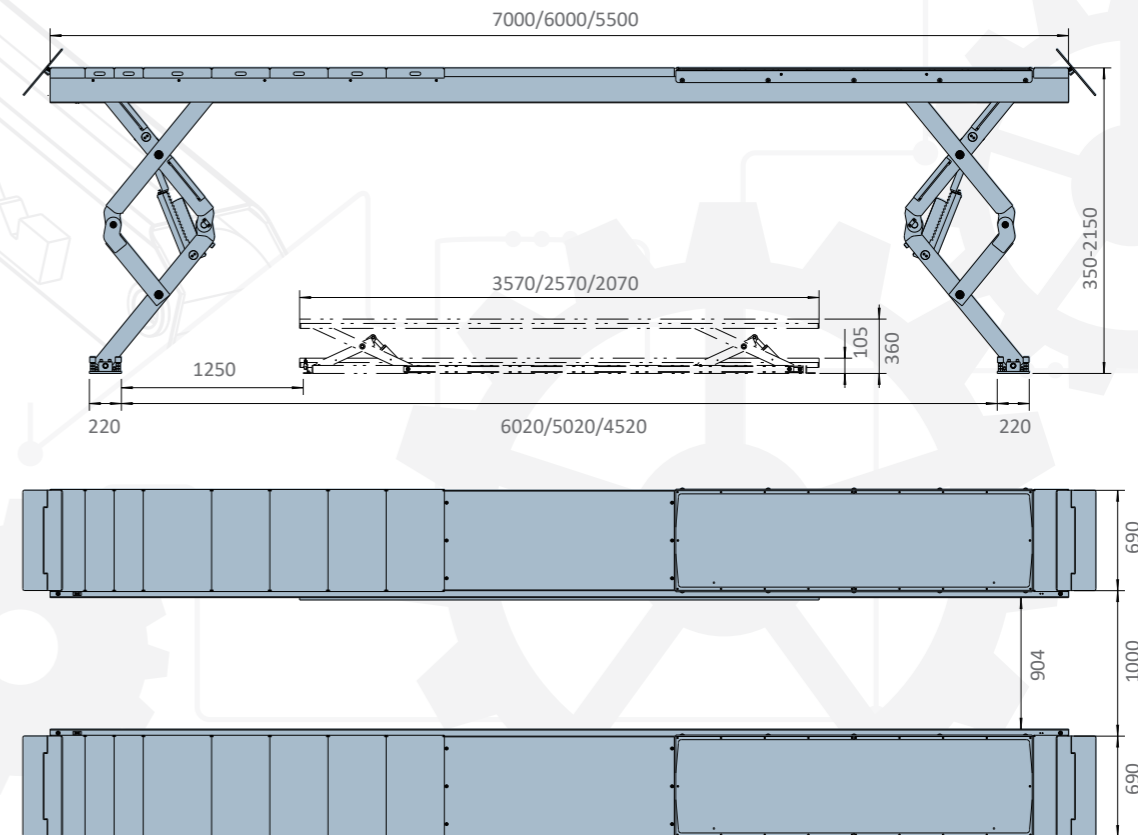

**EX8B**  
**INDEPENDENT SCISSOR LIFT**

- Maximum Lift Height: 2150 mm
- Platform Length Options: 5500 mm, 6000 mm, 7000 mm
- Maximized Open Space: Unique arm structures provide exceptional clearance around and underneath the lifted vehicle.
- Synchronization Technology: Constantly detects and corrects height deviations across all four scissor supports.
- Intelligent Touch Display: User-friendly interface for system parameter setup and for real-time parameter display (Not for lift operation control)
- Mechanical Safeguards: Integrated mechanical safety latches with continuous locking status detection, guarding against any unexpected loss of synchronization.
- Standard Magnetic LED lamp for optimal lighting.
- Standard runway rails accept optional jacking beams.
- Wheel Alignment Components  
Standard pneumatically-controlled slip plates integrated with the runway.  
Optional Radius table, each table has a rated load capacity of 3,000 kg.
- Control Cabinet Placement  
Mount on either side (left/right) of the platform.  
No additional hoses or connectors required for side switching.

**TECHNICAL DATA**

| MODEL NO.           | EX8B                        |
|---------------------|-----------------------------|
| Lifting capacity    | 8.0T                        |
| Max. lifting height | 2150mm                      |
| Min. height         | 350mm                       |
| Longer Platform     | 5500mm/6000mm/7000mm        |
| Capacity of motor   | 3.5kWx2                     |
| Lifting time        | 70S                         |
| Electricity supply  | According To Customer Needs |

\* Machine shown with optional equipment. Actual product appearance may differ.



Low Voltage Control Unit      Mechanical Locking Device  
Pneumatic Release



Pneumatic Rear Side Slip      Drive-on ramp (Optional)



Automatic Recess Cover Plates (Optional)      Aluminum Alloy Turntable (Optional)

**3.0T**   
CJ | Pneumatic Rolling Jack



**3.0T**   
SCJ | Pneumatic Rolling Jack



**MAIN FEATURES**

- Durable and compact scissor carrying structure.
- Adjustable width between support wheels to fit different widths between runways.
- Extendable jacking beam for various wheelbases.
- With manual release mechanical safety locking unit.
- Steel-made sliding rolls with ball-bearings move easily and smoothly on the track.
- Manual or pneumatic drive.

**DC Power**



**4.0T**   
J40E | Battery Driven Rolling Jack

**MAIN FEATURES**

- 4-Ton Lifting Capacity: Handle most sedans, large MPVs, heavy-duty SUVs, pickup trucks, and light trucks.
- Wide Wheelbase Compatibility: An adjustable support beam (880mm - 1920mm) accommodates vehicles with broader stances, including large MPVs, heavy-duty pickups, and even school buses.
- An effective height of 400mm over platform, sufficient to lift large tires to a free-rolling state. (R22, approx. 850mm diameter)
- Minimum Height over platform : 110mm, easy access for low-clearance vehicles
- Powered by Lead-acid battery. A full charge delivers approximately 60 lifting cycles at rated capacity (at 20°C ambient temperature).
- Electric Hydraulic Drive, low operating noise.
- Electric push-button control for easy and convenient operation.
- Mechanical Locks with electric release, no external air supply required.
- Standard Jack includes 4 height extensions for increased lifting height. (2 pieces with an effective height of 100mm and 2 pieces with an effective height of 50mm)
- Mechanical Safety Locks: Prevent uncontrolled descent.
- Two-button Descent Operation: Prevent accidental crushing due to accidental lowering.
- Spring-Loaded Cradle Structure: Prevent unintended movement.

**OVERALL DIMENSION**

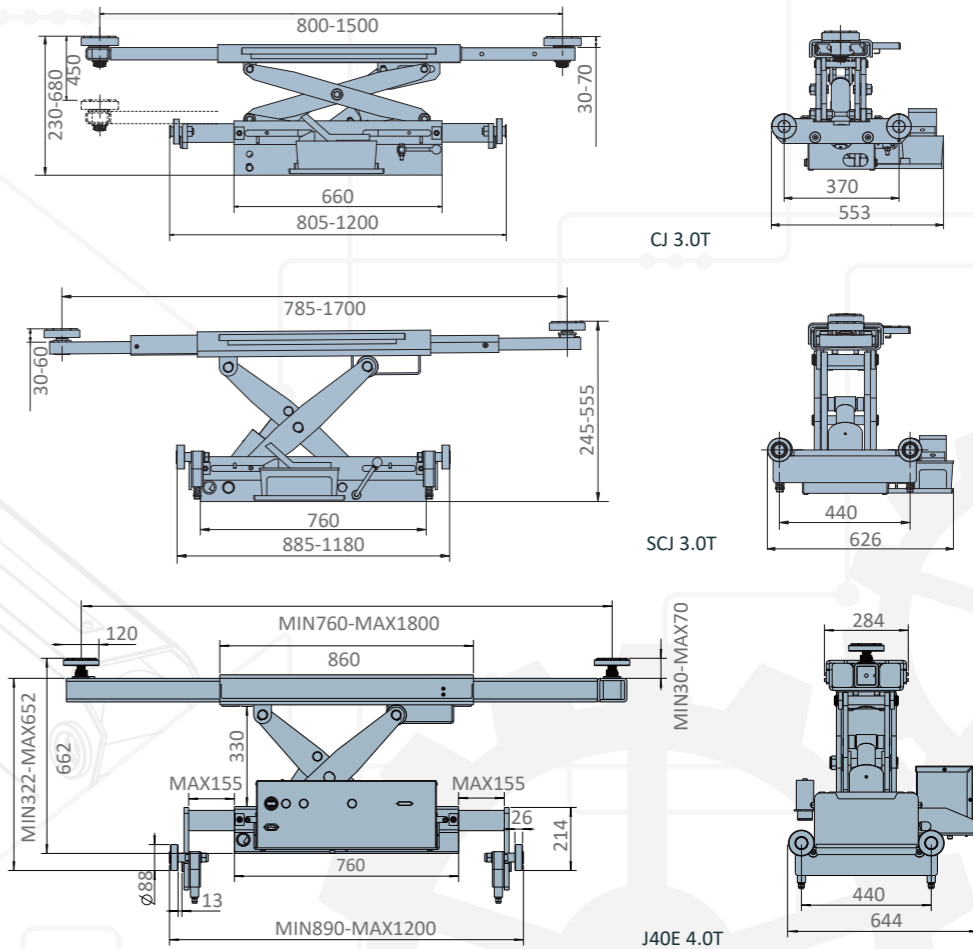

**TECHNICAL DATA**

| Model NO.              | CJ          | SCJ        | J40E          |
|------------------------|-------------|------------|---------------|
| Type                   | Manual Pump | Air Pump   | Electric Pump |
| Lifting capacity       | 3.0T        | 3.0T       | 4.0T          |
| Max stroke             | 450mm       | 450mm      | 330mm         |
| Initial height         | 230mm       | 230mm      | 322mm         |
| Platform width         | 805-1200mm  | 805-1200mm | 890-1200mm    |
| Width between adapters | 800-1500mm  | 800-1500mm | 760-1800mm    |
| Support beam           | Two stage   | Two stage  | Three stage   |
| Air supply             | /           | 6-8bar     | /             |
| Rated oil pressure     | 24MPa       | 24MPa      | 24MPa         |
| Weight                 | 160kg       | 170kg      | 170kg         |

\* Technical data and composition presented in this catalogue may vary. Pictures reproduced are only indicative.

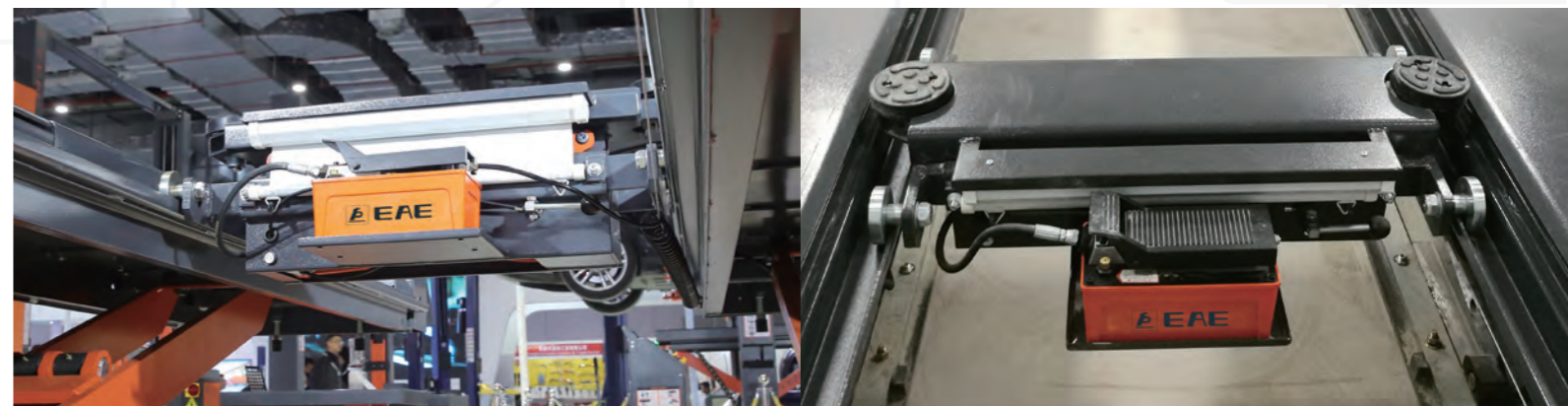

1.0T  
Lifting Capacity

Max Lifting Height  
1200mm

Hydraulic  
Driven System



**OVERALL DIMENSION**

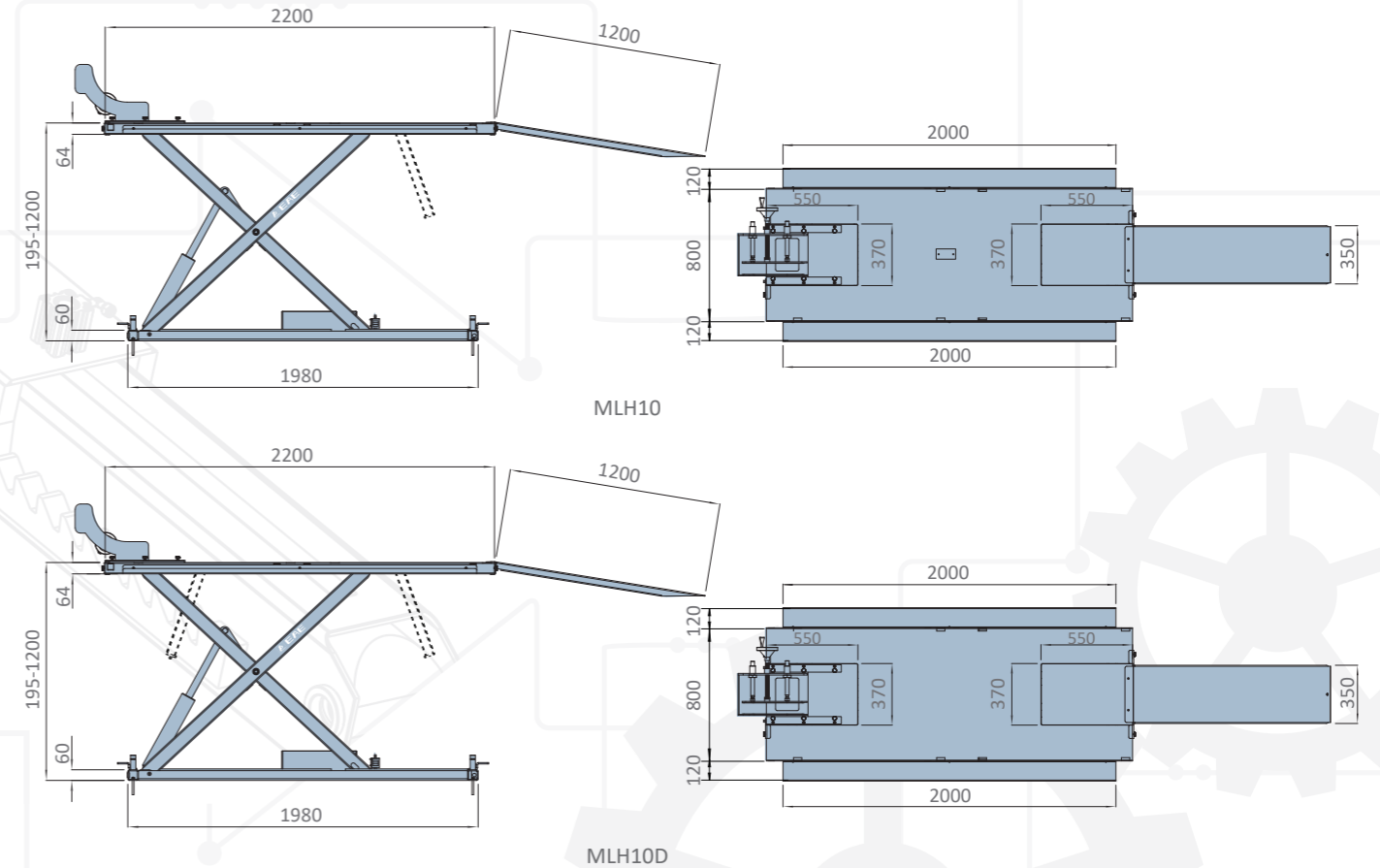

**MLH10/MLH10D**

**HYDRAULIC LIFTING TABLE**

- With a maximal lifting capacity of 1.0T, a rise height of 1200mm and the platform being as wide as 800mm, it is fit for service and repair to various sizes of motorcycle. Surface mounting.
- Built-in power unit. Good looking and space saving.
- Rising and lowering movement is easily done using a magnetic hand-held control unit with 24V operative voltage.
- Electrical release device. It is very convenient to disengage the mechanical locking unit for lowering operation.
- The ramp is made as low as an angle of 10 degrees for easier drive-on.
- The drop-down plates are available at both ends of the platform for model EE-MLH10D.
- The drop-down plate is available at the rear side of the lifting platform for model EE-MLH10.
- Robust and automatic mechanical locking device.
- Protective device against leakage. No unexpected collapse in case of oil hose breakage.
- Hydraulically protected against overloading.
- Standard manually-operated wheel-clamping device. Its width is adjustable so as to fit the most types of tires.
- Tool tray at both sides.
- Each side of the lifting platform is reserved with 4 slots for binding straps so as to satisfy stability requirement in various working circumstances.

**TECHNICAL DATA**

| MODEL NO        | MLH10/MLH10D |
|-----------------|--------------|
| Rated load      | 1.0T         |
| Platform length | 2200mm       |
| Platform width  | 800mm        |
| Rise height     | 1200mm       |
| Initial height  | 195mm        |
| Rise time       | Approx.30s   |
| Voltage         | 220V         |
| Power           | 0.75kW       |

\* Machine shown with optional equipment. Actual product appearance may differ.



Manually operated wheel clamp.

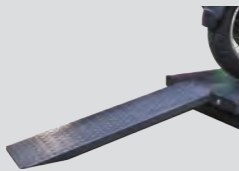

Drive-on ramp  
As low as an angle of 10 degrees.



A horizontal type of power unit saves your space.



Electrical release device



Mobile kit



Magnetic hand-held control unit with 24V operative voltage.

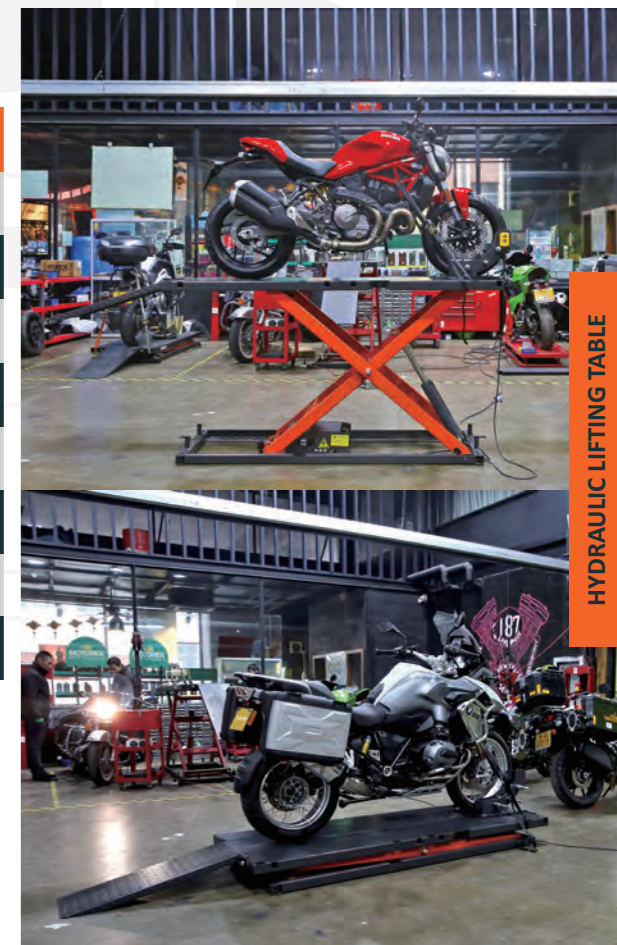

HYDRAULIC LIFTING TABLE

8.0T/10T Per Column | Wired and Wireless | HMI Screen | CE

**QUIKMULTI**



AC Power Supply Available.

HDM88 64T



HDM82 16T



# HDM SERIES

## HEAVY DUTY MOBILE COLUMN

- Each column has a maximum lifting capacity of 8.0T/10T.
- A maximum combination of 48 independent columns.
- Wireless and wired signal processing.
- Easier means for setting up the networks and selecting control modes.
- Battery powered, the lifting procedure starts without much work for setting up.
- HMI screen for setting networks, working modes and displaying crucial parameters. Tap the ID card to activate and access the control system.
- Audible warning for the final travel of lowering movement.
- The lifting system is battery powered. Each column has a charger rating of AC110-240V-1Ph.
- DC24V safe control voltage.
- Adjustable wheel pick-up fork accommodates tire diameter from 500 to 1250mm.
- Adjustable wheel pick-up fork accommodates tire diameter from 500 to 1500 mm for HDMW series.

### OVERALL DIMENSION

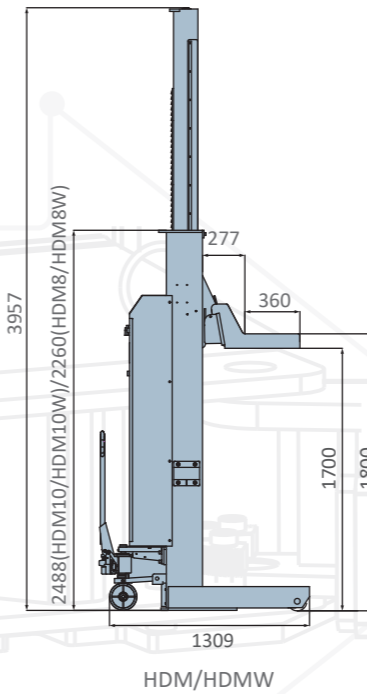

HDM SERIES

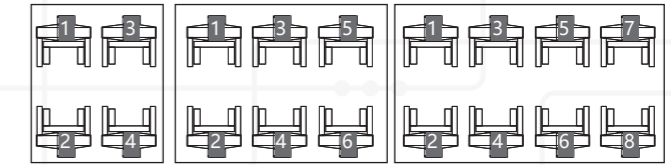

HDM84/32T  
HDM104/40T

HDM86/48T  
HDM106/60T

HDM88/64T  
HDM108/80T

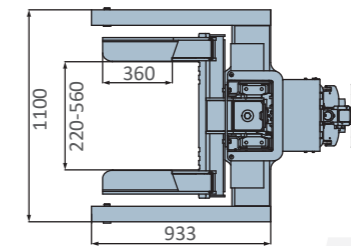

HDM

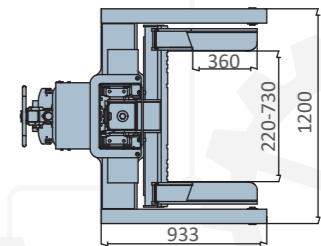

HDMW (Wide Version)

### TECHNICAL DATA

| MODEL NO.                       | HDM8        | HDM8W       | HDM10       | HDM10W      |
|---------------------------------|-------------|-------------|-------------|-------------|
| Single column capacity          | 8.0T        | 8.0T        | 10T         | 10T         |
| Locking release                 | Electric    | Electric    | Electric    | Electric    |
| Max. lifting height             | 1800mm      | 1800mm      | 1800mm      | 1800mm      |
| Min. height                     | 159mm       | 159mm       | 159mm       | 159mm       |
| Full-rise time under rated load | Approx. 85S | Approx. 85S | Approx. 85S | Approx. 85S |
| Motor power                     | 2.2kW       | 2.2kW       | 2.2kW       | 2.2kW       |
| Oil reservoir                   | 14L         | 14L         | 14L         | 14L         |
| Relief Pressure                 | 22Mpa       | 22Mpa       | 22Mpa       | 22Mpa       |
| Approximate Tire Size           | 500-1250mm  | 500-1500mm  | 500-1250mm  | 500-1500mm  |

\* Machine shown with optional equipment. Actual product appearance may differ.



HMI Screen (Optional weight indicator)

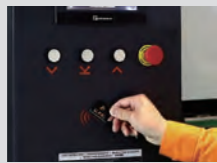

Control is only permitted at a authorized column



Adjustable wheel supports



Accurate control for synchronization

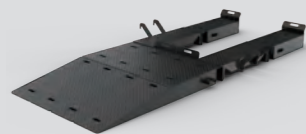

Portable forklift runway kit (Optional)



Support Stands (Optional)



Crossbeam support and Triangle height extension support (Optional)



Height extension support 200mm and Beam support (Optional)



HEAVY DUTY LIFT

8.0T/10T Per Column | IP65 Protection Resistant To Water Spay | HMI Screen | CE

**QUIKMULTI**



# HDMG SERIES

## HEAVY DUTY MOBILE COLUMN

- Capacity: 8.0T/10T per column.
- Corrosion-Resistant, suitable for wet or humid environments like wash bays.
- Hot-Dip Galvanized Structural Components, Stainless Steel Control Cover and Anti-Corrosion Fasteners.
- IP65 Protection: Resistant to water spay.
- Cordless, Battery Powered: Eliminate tripping hazards and enhance Mobility.
- Wireless Radio Control: Enable safe and efficient control at any column.
- Adjustable wheel pick-up fork: Accommodate tire diameter from 500 to 1250mm.
- HMI screen: Simplified way for linkage and modes selection.
- Control voltage: DC24V
- Charger Rating: AC 110-240V, 1-phase (per column).

### OVERALL DIMENSION

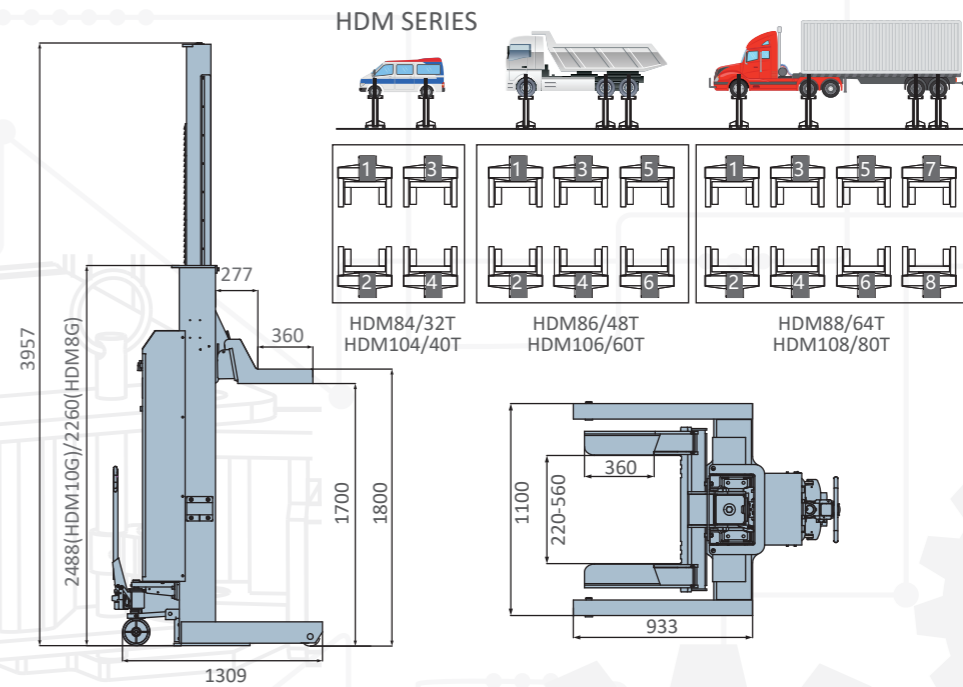

### TECHNICAL DATA

| MODEL NO.                       | HDM8G       | HDM10G      |
|---------------------------------|-------------|-------------|
| Single column capacity          | 8.0T        | 10T         |
| Locking release                 | Electric    | Electric    |
| Max. lifting height             | 1800mm      | 1800mm      |
| Min. height                     | 159mm       | 159mm       |
| Full-rise time under rated load | Approx. 85S | Approx. 85S |
| Motor power                     | 2.2kW       | 2.2kW       |
| Oil reservoir                   | 14L         | 14L         |
| Relief Pressure                 | 22Mpa       | 22Mpa       |
| Approximate Tire Size           | 500-1250mm  | 500-1250mm  |

\* Machine shown with optional equipment. Actual product appearance may differ.





## EAE Automotive Equipment Company Limited

EAE Wujiang | 1089 North Yunlian Rd.  
Wujiang Suzhou  
Tel 0086-512-63032886

EAE Shanghai | Rm 501, Bldg 2, No.600,  
West Yunling Rd. Putuo, Shanghai  
Tel/Fax 0086-21-32500750/32500785

EAE UK | 101 Longden Road, Shrewsbury,  
Shropshire SY3 9PS  
Tel/Fax 44 844 800 7522/44 844 800 7523



[www.eae-ae.com](http://www.eae-ae.com) Toll Free Call:400 9911 109 [sales@eae-ae.com](mailto:sales@eae-ae.com)